

INDICE DELLA TAVOLE  
 INDEX OF TABLES  
 RÉPERTOIRE DES PLANCHES  
 TAFELVERZEICHNIS  
 INDICE DE FIGURAS

MOD. MACCHINA  
 MOD. MACHINE  
 MOD. MACHINE  
 MOD. MACHINE  
 MOD. MACCHINA

**18 / 20 / 22-3W**  
 No. 12 - MACCHINA 158H

Fig. No.	Fig. No.	Fig. No.	Fig. No.	Fig. No.	Fig. No.	Fig. No.	Fig. No.	
Fig. No.	Fig. No.	Fig. No.	Fig. No.	Fig. No.	Fig. No.	Fig. No.	Fig. No.	
1	2	3	4	5	6	7	8	
INDICE DELLA TAVOLE INDEX OF TABLES RÉPERTOIRE DES PLANCHES TAFELVERZEICHNIS INDICE DE FIGURAS	MOTOR ENGINE MOTORS MOTOR	CARROZZERIA BODY CARROSSERIE CARROSERIE	TELAIIO CHASSIS CHASSIS RAHMEN	STEERING DIRECTION DIRECTION LENKUNG	FRIZIONE SEMPLICE SINGLE PLATE CLUTCH MONODISQUE EMBRAYAGE EINSCHNITZ KUPPLUNG	DOPPIA FRIZIONE DOUBLE CLUTCH EMBRAYAGE DOUBLE ZWEIFACHKUPPLUNG	A1 A2 A3	A4 A5 A6 A7 A8 A9 A10 A11 A12 A13 A14
INDICE DELLA TAVOLE INDEX OF TABLES RÉPERTOIRE DES PLANCHES TAFELVERZEICHNIS INDICE DE FIGURAS	MOTOR ENGINE MOTORS MOTOR	CARROZZERIA BODY CARROSSERIE CARROSERIE	TELAIIO CHASSIS CHASSIS RAHMEN	STEERING DIRECTION DIRECTION LENKUNG	FRIZIONE SEMPLICE SINGLE PLATE CLUTCH MONODISQUE EMBRAYAGE EINSCHNITZ KUPPLUNG	DOPPIA FRIZIONE DOUBLE CLUTCH EMBRAYAGE DOUBLE ZWEIFACHKUPPLUNG	A1 A2 A3	A4 A5 A6 A7 A8 A9 A10 A11 A12 A13 A14

**A1**

A2

21

COMANDO IN COORDINAZIONE CON IL SERVIZIO  
COMANDO IN COORDINAZIONE CON IL SERVIZIO  
COMANDO IN COORDINAZIONE CON IL SERVIZIO  
COMANDO IN COORDINAZIONE CON IL SERVIZIO

20

COMANDO IN COORDINAZIONE CON IL SERVIZIO  
COMANDO IN COORDINAZIONE CON IL SERVIZIO  
COMANDO IN COORDINAZIONE CON IL SERVIZIO  
COMANDO IN COORDINAZIONE CON IL SERVIZIO

19

COMANDO IN COORDINAZIONE CON IL SERVIZIO  
COMANDO IN COORDINAZIONE CON IL SERVIZIO  
COMANDO IN COORDINAZIONE CON IL SERVIZIO  
COMANDO IN COORDINAZIONE CON IL SERVIZIO

18

17  
16  
15  
14  
13

COMANDO IN COORDINAZIONE CON IL SERVIZIO  
COMANDO IN COORDINAZIONE CON IL SERVIZIO  
COMANDO IN COORDINAZIONE CON IL SERVIZIO  
COMANDO IN COORDINAZIONE CON IL SERVIZIO

12

COMANDO IN COORDINAZIONE CON IL SERVIZIO  
COMANDO IN COORDINAZIONE CON IL SERVIZIO  
COMANDO IN COORDINAZIONE CON IL SERVIZIO  
COMANDO IN COORDINAZIONE CON IL SERVIZIO

11

COMANDO IN COORDINAZIONE CON IL SERVIZIO  
COMANDO IN COORDINAZIONE CON IL SERVIZIO  
COMANDO IN COORDINAZIONE CON IL SERVIZIO  
COMANDO IN COORDINAZIONE CON IL SERVIZIO

10

COMANDO IN COORDINAZIONE CON IL SERVIZIO  
COMANDO IN COORDINAZIONE CON IL SERVIZIO  
COMANDO IN COORDINAZIONE CON IL SERVIZIO  
COMANDO IN COORDINAZIONE CON IL SERVIZIO

9

INDICE DEL TABELLARIO  
TABELLARIO  
TABELLARIO  
TABELLARIO

INDICE DEL TABELLARIO  
TABELLARIO  
TABELLARIO  
TABELLARIO

18/20/22-3M

INDICE DEL TABELLARIO  
TABELLARIO  
TABELLARIO  
TABELLARIO

INDICE DEL TABELLARIO  
TABELLARIO  
TABELLARIO  
TABELLARIO

INDICE DELLE TAVOLE  
 INDEX OF TABLES  
 REPERTOIRE DES PLANCHES  
 TABELLEZEECHNIS  
 INDICE DE FIGURAS

MOD. MASCHINA  
 MOD. MACHINE  
 MOD. MASCHINE  
 MOD. MACHINE  
 MOD. MASCHINA  
 MOD. MACHINE

**18 / 20 / 22-3W**

No. 43 - MACCII - 1988

Fig.	Descrizione	Fig.	Descrizione
22	FRONT ELECTR. COMMAND BRAKES AND CONTROLS FRANS ET MOULTE COMMANDES BREMSEN UND STEUERUNGEN FRENOS Y MANDOS	D5	D10
23	ATTACCO A TRE PUNTI THREE POINT HITCH PACKAGE A TILAGE A TROIS POINTS DREI-PUNKT ANSCHLUSS ENGAÑCHE EN 3 PUNTOS	D13	D14
24	PIANTO EL. ETRICO ELECTRICAL SYSTEM INSTALLATION ELECTRIQUE ELEKTRISCHE ANLAGE INSTALACION ELECTRICA	E1	E2
25	RUOTE WHEELS ROUES RUEDAS	E3	
26	ACCESSORI ACCESSORIES ACCESSOIRES ZUBEHÖR ACCESORIOS	E4	
27	PRESA DI POTENZA ANTERIORE FRONT POWER TAKE-OFF PRISE DE FORCE AVANT VORDERE ZAPFWELLE TOMA DE FUERZA DELANTERA	E5	

**A3**

Designação de matéria  
 Designation of matter  
 Designation de matière  
 Designation de matière

Com portafolho anterior  
 With front folder  
 Avec portafolho avant

Without front folder

(Sem portafolho) anterior

No. peça	Qtd. por unidade	Part. no.	Nome da peça	No. peça	Qtd. por unidade	Part. no.	Nome da peça
1	15 0016 010	49	5 0016 5 5	35	45 0036 524	35	45 0036 524
2	15 0016 056	19	5 0016 0 0	36	84 3613 010	36	84 3613 010
3	15 0036 057	20	84 3613 000	37	06 2555 011	37	06 2555 011
4	83 4317 510	81	84 3613 000	38	06 2555 011	38	06 2555 011
5	15 0036 510	82	45 0036 510	39	45 0036 524	39	45 0036 524
6	45 0036 590	29	84 3613 010	40	15 0036 524	40	15 0036 524
7	61 1550 000	24	64 0510 000	41	82 4815 010	41	82 4815 010
8	45 0036 505	25	64 0510 000	42	63 8865 000	42	63 8865 000
9	45 0036 510	26	84 3613 000	43	86 1807 050	43	86 1807 050
10	45 0036 440	21	15 0036 510	44	81 1216 000	44	81 1216 000
11	96 1601 000	28	84 3613 010	45	45 0036 520	45	45 0036 520
12	84 9244 010	23	04 3548 001	46	45 0036 523	46	45 0036 523
13	84 3921 000	30	60 2281 000	47	15 0036 418	47	15 0036 418
14	86 1410 050	31	45 0036 520		15 0036 819		15 0036 819
15	81 4618 000	32	41 0017 0 9		15 0036 819		15 0036 819
16	84 1801 100	33	66 2414 0 0		63 4317 050		63 4317 050
17	45 0036 524	34	85 1219 000		63 4317 010		63 4317 010

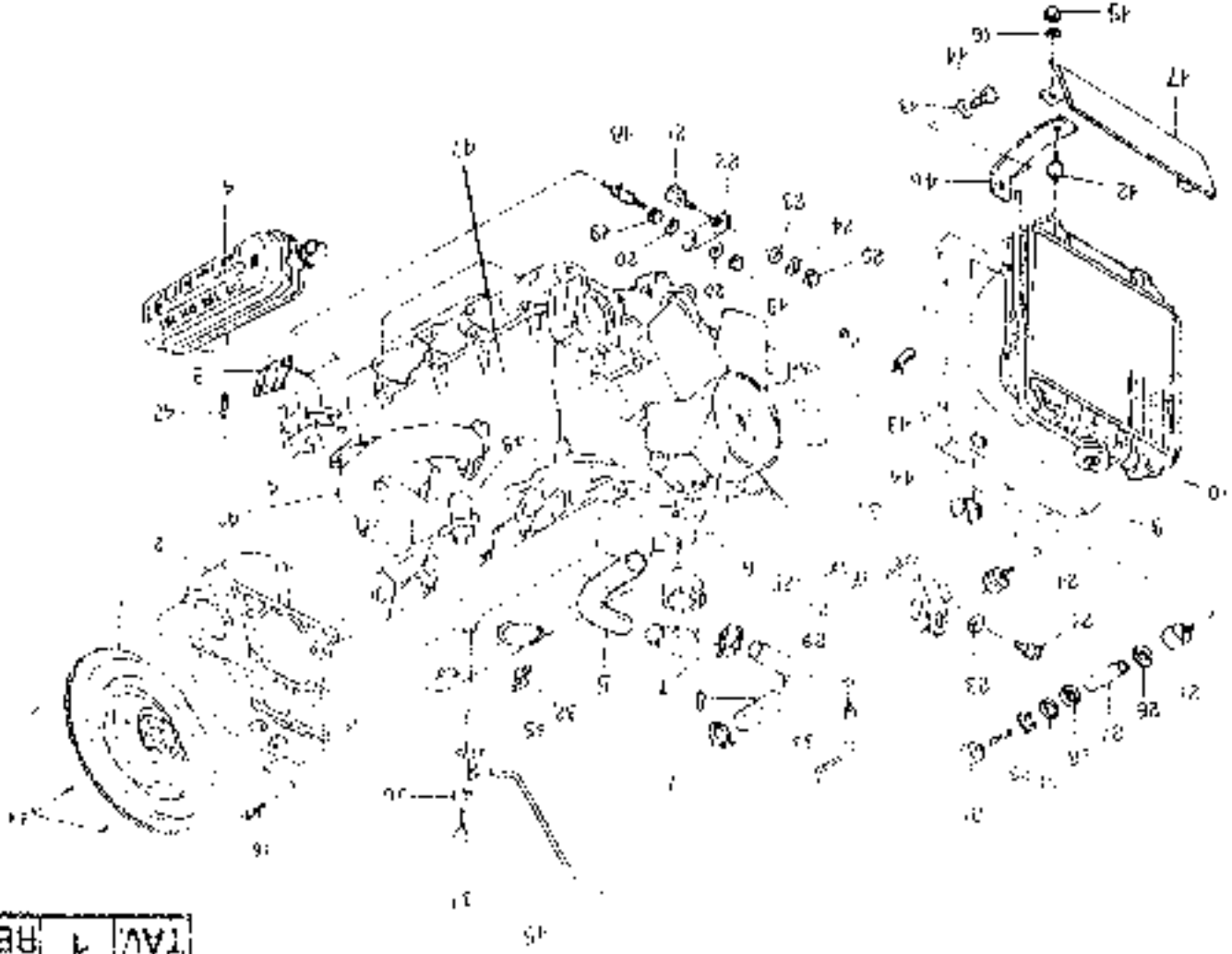

TAV 1 REV

MOD 18/20/22-3W





1960  
 1961  
 1962  
 1963  
 1964  
 1965  
 1966  
 1967  
 1968  
 1969  
 1970

Year	1960	1961	1962	1963	1964	1965	1966	1967	1968	1969	1970
1	1000000	1000000	1000000	1000000	1000000	1000000	1000000	1000000	1000000	1000000	1000000
2	1000000	1000000	1000000	1000000	1000000	1000000	1000000	1000000	1000000	1000000	1000000
3	1000000	1000000	1000000	1000000	1000000	1000000	1000000	1000000	1000000	1000000	1000000
4	1000000	1000000	1000000	1000000	1000000	1000000	1000000	1000000	1000000	1000000	1000000
5	1000000	1000000	1000000	1000000	1000000	1000000	1000000	1000000	1000000	1000000	1000000
6	1000000	1000000	1000000	1000000	1000000	1000000	1000000	1000000	1000000	1000000	1000000
7	1000000	1000000	1000000	1000000	1000000	1000000	1000000	1000000	1000000	1000000	1000000
8	1000000	1000000	1000000	1000000	1000000	1000000	1000000	1000000	1000000	1000000	1000000
9	1000000	1000000	1000000	1000000	1000000	1000000	1000000	1000000	1000000	1000000	1000000
10	1000000	1000000	1000000	1000000	1000000	1000000	1000000	1000000	1000000	1000000	1000000
11	1000000	1000000	1000000	1000000	1000000	1000000	1000000	1000000	1000000	1000000	1000000
12	1000000	1000000	1000000	1000000	1000000	1000000	1000000	1000000	1000000	1000000	1000000
13	1000000	1000000	1000000	1000000	1000000	1000000	1000000	1000000	1000000	1000000	1000000
14	1000000	1000000	1000000	1000000	1000000	1000000	1000000	1000000	1000000	1000000	1000000
15	1000000	1000000	1000000	1000000	1000000	1000000	1000000	1000000	1000000	1000000	1000000
16	1000000	1000000	1000000	1000000	1000000	1000000	1000000	1000000	1000000	1000000	1000000
17	1000000	1000000	1000000	1000000	1000000	1000000	1000000	1000000	1000000	1000000	1000000
18	1000000	1000000	1000000	1000000	1000000	1000000	1000000	1000000	1000000	1000000	1000000
19	1000000	1000000	1000000	1000000	1000000	1000000	1000000	1000000	1000000	1000000	1000000
20	1000000	1000000	1000000	1000000	1000000	1000000	1000000	1000000	1000000	1000000	1000000
21	1000000	1000000	1000000	1000000	1000000	1000000	1000000	1000000	1000000	1000000	1000000
22	1000000	1000000	1000000	1000000	1000000	1000000	1000000	1000000	1000000	1000000	1000000
23	1000000	1000000	1000000	1000000	1000000	1000000	1000000	1000000	1000000	1000000	1000000
24	1000000	1000000	1000000	1000000	1000000	1000000	1000000	1000000	1000000	1000000	1000000
25	1000000	1000000	1000000	1000000	1000000	1000000	1000000	1000000	1000000	1000000	1000000
26	1000000	1000000	1000000	1000000	1000000	1000000	1000000	1000000	1000000	1000000	1000000
27	1000000	1000000	1000000	1000000	1000000	1000000	1000000	1000000	1000000	1000000	1000000
28	1000000	1000000	1000000	1000000	1000000	1000000	1000000	1000000	1000000	1000000	1000000
29	1000000	1000000	1000000	1000000	1000000	1000000	1000000	1000000	1000000	1000000	1000000
30	1000000	1000000	1000000	1000000	1000000	1000000	1000000	1000000	1000000	1000000	1000000
31	1000000	1000000	1000000	1000000	1000000	1000000	1000000	1000000	1000000	1000000	1000000
32	1000000	1000000	1000000	1000000	1000000	1000000	1000000	1000000	1000000	1000000	1000000
33	1000000	1000000	1000000	1000000	1000000	1000000	1000000	1000000	1000000	1000000	1000000
34	1000000	1000000	1000000	1000000	1000000	1000000	1000000	1000000	1000000	1000000	1000000
35	1000000	1000000	1000000	1000000	1000000	1000000	1000000	1000000	1000000	1000000	1000000
36	1000000	1000000	1000000	1000000	1000000	1000000	1000000	1000000	1000000	1000000	1000000
37	1000000	1000000	1000000	1000000	1000000	1000000	1000000	1000000	1000000	1000000	1000000
38	1000000	1000000	1000000	1000000	1000000	1000000	1000000	1000000	1000000	1000000	1000000
39	1000000	1000000	1000000	1000000	1000000	1000000	1000000	1000000	1000000	1000000	1000000
40	1000000	1000000	1000000	1000000	1000000	1000000	1000000	1000000	1000000	1000000	1000000
41	1000000	1000000	1000000	1000000	1000000	1000000	1000000	1000000	1000000	1000000	1000000
42	1000000	1000000	1000000	1000000	1000000	1000000	1000000	1000000	1000000	1000000	1000000
43	1000000	1000000	1000000	1000000	1000000	1000000	1000000	1000000	1000000	1000000	1000000
44	1000000	1000000	1000000	1000000	1000000	1000000	1000000	1000000	1000000	1000000	1000000
45	1000000	1000000	1000000	1000000	1000000	1000000	1000000	1000000	1000000	1000000	1000000
46	1000000	1000000	1000000	1000000	1000000	1000000	1000000	1000000	1000000	1000000	1000000
47	1000000	1000000	1000000	1000000	1000000	1000000	1000000	1000000	1000000	1000000	1000000
48	1000000	1000000	1000000	1000000	1000000	1000000	1000000	1000000	1000000	1000000	1000000
49	1000000	1000000	1000000	1000000	1000000	1000000	1000000	1000000	1000000	1000000	1000000
50	1000000	1000000	1000000	1000000	1000000	1000000	1000000	1000000	1000000	1000000	1000000



1960  
 1961  
 1962  
 1963  
 1964  
 1965  
 1966  
 1967  
 1968  
 1969  
 1970

Designation de valises  
 Etiquetas de valises  
 Designation de valises  
 Etiquetas de valises



No. pieza	No. de pedido	No. de orden	No. de pieza	No. de pedido	No. de orden
1	15.006.445	15.006.445	10	08.341.0	
2	15.006.445	15.006.445	19	19.003.902	
3	19.002.916			19.003.901	
4	86.1802.000	15.006.445	20	15.006.445	
5	19.002.255			15.006.445	
6	86.1820.000		21	84.3124.000	
7	06.1094.050		22	84.4700.000	
8	18.002.900		23	81.4517.010	
0	48.255.016		24	15.006.445	15.006.445
10	51.270.000				
11	18.002.308				
12	00.8036.000				
13	04.9529.010				
14	81.4517.010				
15	81.4514.000				
16	43.274.000				
17	15.006.445				

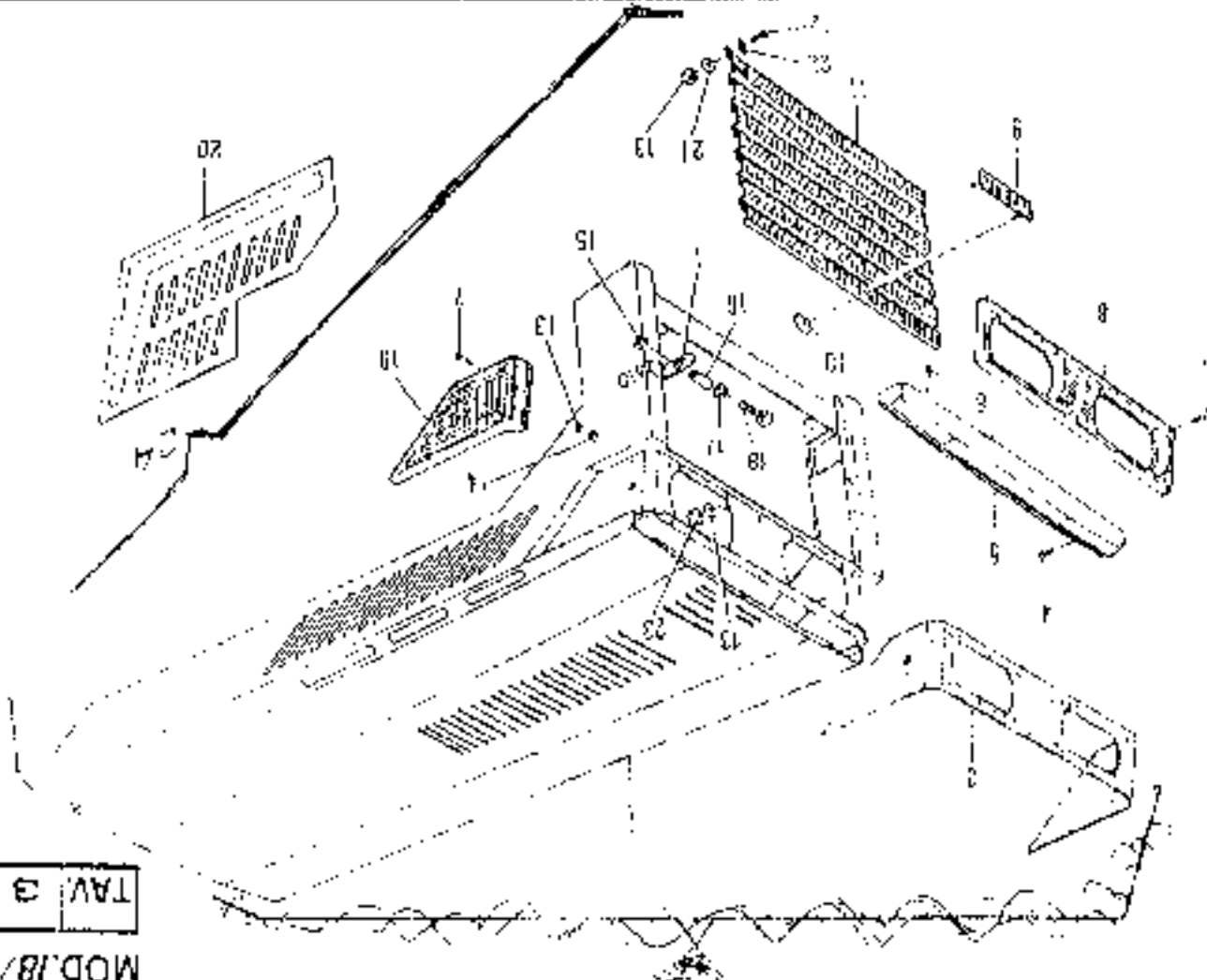

MOD.18/20/22-3W  
 TAV. 3 REV.



CON PERIATREZZI ANTERIORE  
 WITH FRONT TOOLS HOLDER  
 AVEC PORTS OUTLS AVANT

Separation di valigia  
 Signification de valija  
 Signification de valija  
 Separation de valijas

No. di ordination Part No No. de commande Part No	No. di ordination Part No No. de commande Part No	No. di ordination Part No No. de commande Part No	No. di ordination Part No No. de commande Part No	No. di ordination Part No No. de commande Part No	No. di ordination Part No No. de commande Part No
1	15.0036.785				
2	79.0032.256				
3	45.0036.207				
4	86.4807.000				
5	86.4820.000				
6	81.4581.000				
7	84.3673.000				
8	84.3685.000				
9	86.2555.000				
10	81.4627.000				
11	49.2274.000				
12	45.0036.272				
13	86.3751.050				
14	45.0036.525				

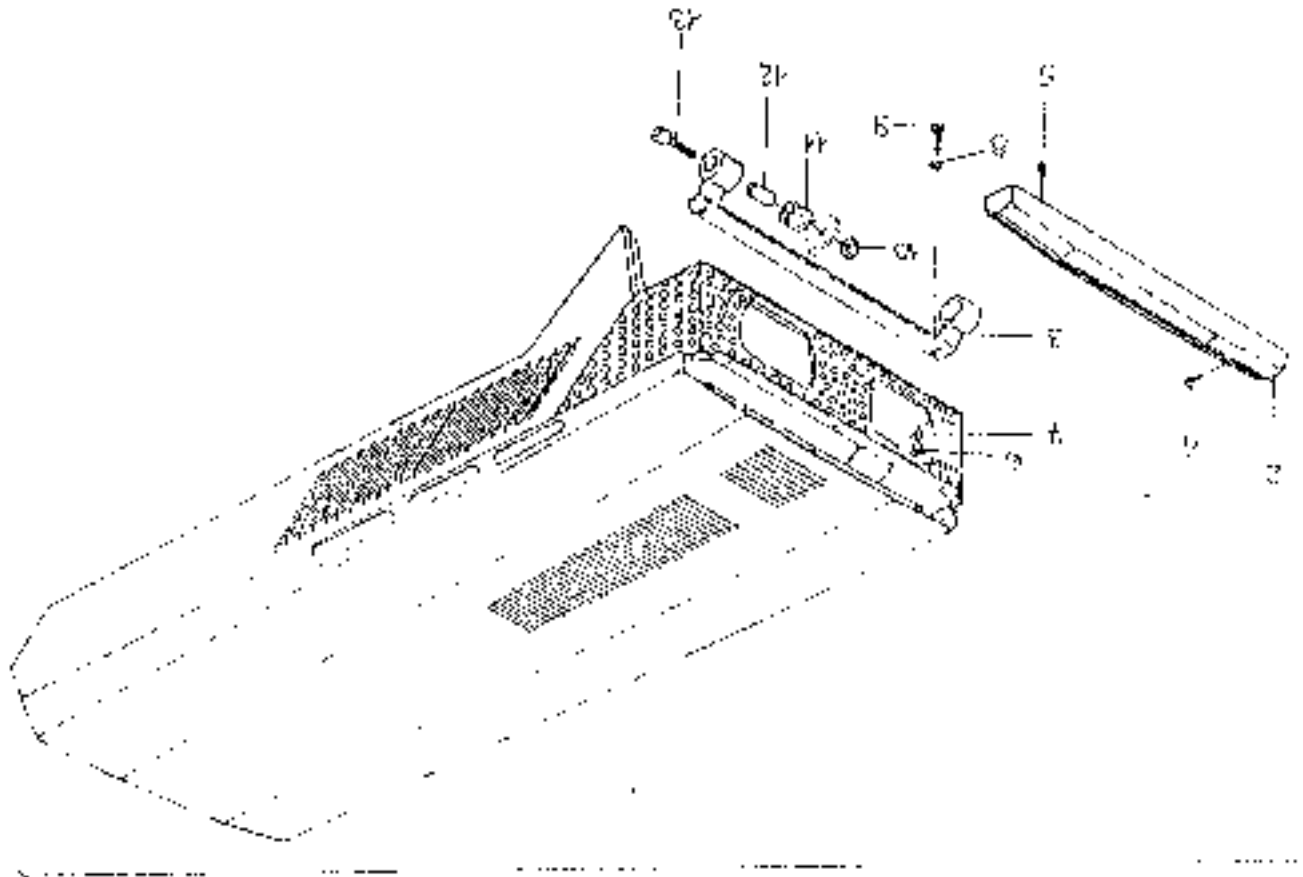

MOD.18/20/22-3W  
 TAV 4 REV

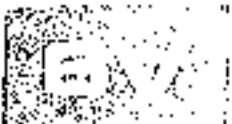

UNITED STATES DEPARTMENT OF AGRICULTURE

Division of Entomology  
Bureau of Entomology and Plant Quarantine  
Washington, D. C.

INSECT COLLECTIONS

ENTOMOLOGICAL

No.	Name	Sex	Date	Locality	Collector	Remarks
1	...	...	...	...	...	...
2	...	...	...	...	...	...
3	...	...	...	...	...	...
4	...	...	...	...	...	...
5	...	...	...	...	...	...
6	...	...	...	...	...	...
7	...	...	...	...	...	...
8	...	...	...	...	...	...
9	...	...	...	...	...	...
10	...	...	...	...	...	...
11	...	...	...	...	...	...
12	...	...	...	...	...	...
13	...	...	...	...	...	...
14	...	...	...	...	...	...
15	...	...	...	...	...	...
16	...	...	...	...	...	...
17	...	...	...	...	...	...
18	...	...	...	...	...	...
19	...	...	...	...	...	...
20	...	...	...	...	...	...
21	...	...	...	...	...	...
22	...	...	...	...	...	...
23	...	...	...	...	...	...
24	...	...	...	...	...	...
25	...	...	...	...	...	...
26	...	...	...	...	...	...
27	...	...	...	...	...	...
28	...	...	...	...	...	...
29	...	...	...	...	...	...
30	...	...	...	...	...	...
31	...	...	...	...	...	...
32	...	...	...	...	...	...
33	...	...	...	...	...	...
34	...	...	...	...	...	...
35	...	...	...	...	...	...
36	...	...	...	...	...	...
37	...	...	...	...	...	...
38	...	...	...	...	...	...
39	...	...	...	...	...	...
40	...	...	...	...	...	...
41	...	...	...	...	...	...
42	...	...	...	...	...	...
43	...	...	...	...	...	...
44	...	...	...	...	...	...
45	...	...	...	...	...	...
46	...	...	...	...	...	...
47	...	...	...	...	...	...
48	...	...	...	...	...	...
49	...	...	...	...	...	...
50	...	...	...	...	...	...
51	...	...	...	...	...	...
52	...	...	...	...	...	...
53	...	...	...	...	...	...
54	...	...	...	...	...	...
55	...	...	...	...	...	...
56	...	...	...	...	...	...
57	...	...	...	...	...	...
58	...	...	...	...	...	...
59	...	...	...	...	...	...
60	...	...	...	...	...	...
61	...	...	...	...	...	...
62	...	...	...	...	...	...
63	...	...	...	...	...	...
64	...	...	...	...	...	...
65	...	...	...	...	...	...
66	...	...	...	...	...	...
67	...	...	...	...	...	...
68	...	...	...	...	...	...
69	...	...	...	...	...	...
70	...	...	...	...	...	...
71	...	...	...	...	...	...
72	...	...	...	...	...	...
73	...	...	...	...	...	...
74	...	...	...	...	...	...
75	...	...	...	...	...	...
76	...	...	...	...	...	...
77	...	...	...	...	...	...
78	...	...	...	...	...	...
79	...	...	...	...	...	...
80	...	...	...	...	...	...
81	...	...	...	...	...	...
82	...	...	...	...	...	...
83	...	...	...	...	...	...
84	...	...	...	...	...	...
85	...	...	...	...	...	...
86	...	...	...	...	...	...
87	...	...	...	...	...	...
88	...	...	...	...	...	...
89	...	...	...	...	...	...
90	...	...	...	...	...	...
91	...	...	...	...	...	...
92	...	...	...	...	...	...
93	...	...	...	...	...	...
94	...	...	...	...	...	...
95	...	...	...	...	...	...
96	...	...	...	...	...	...
97	...	...	...	...	...	...
98	...	...	...	...	...	...
99	...	...	...	...	...	...
100	...	...	...	...	...	...

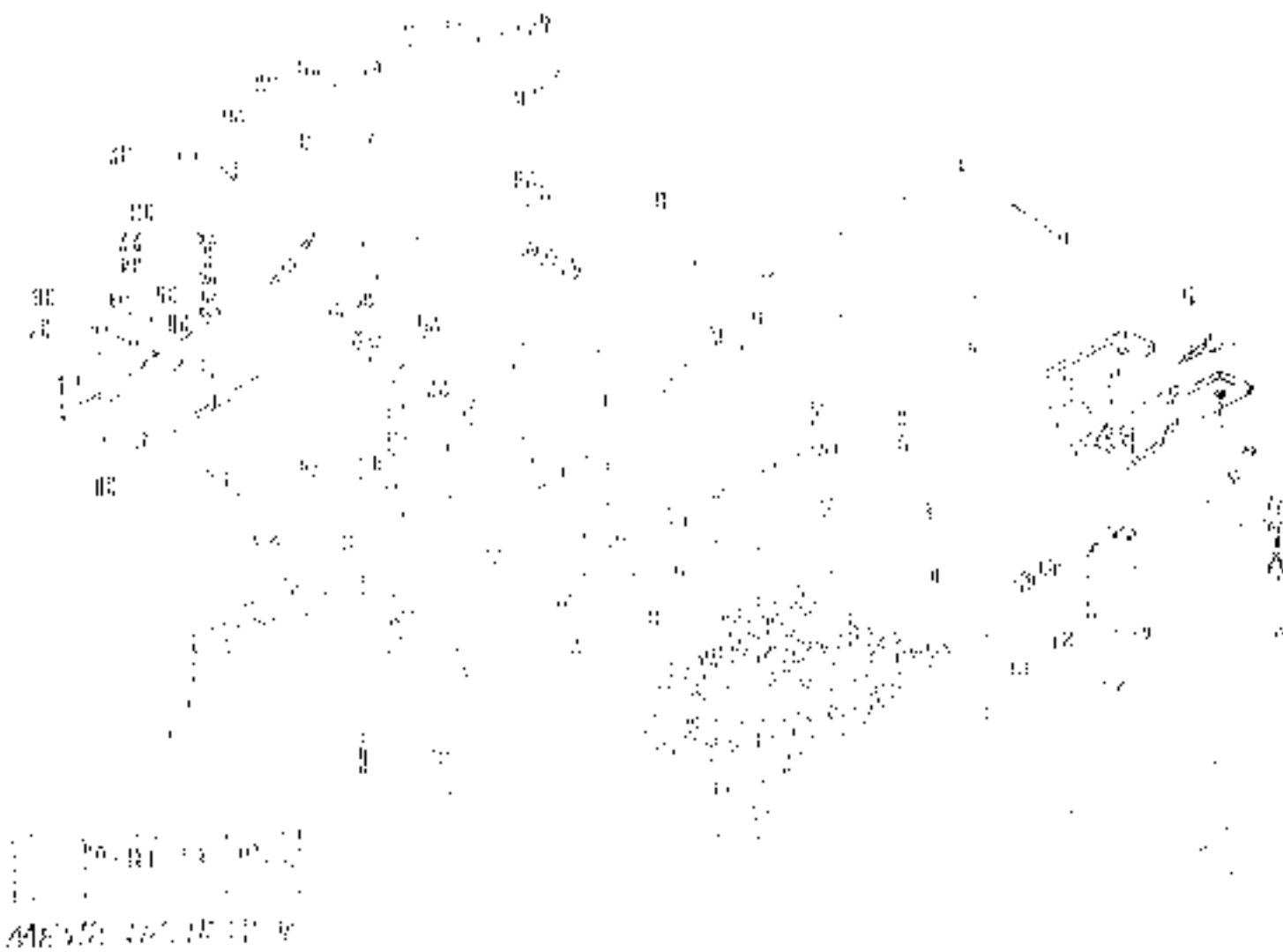



# A13

\* A richiesta  
On request  
Sur demande

Separazione di vendita  
L'age code  
Separation de vente  
Signalisation  
Indicazioni di vendita

No. pezzo No. piece No. part No. N°d Detail - No. No. da pedido	No. di ordinazione Part No. No. piece No. part No. N°d Detail - No. No. da pedido	No. pezzo No. piece No. part No. N°d Detail - No. No. da pedido	No. di ordinazione Part No. No. piece No. part No. N°d Detail - No. No. da pedido	No. pezzo No. piece No. part No. N°d Detail - No. No. da pedido	No. di ordinazione Part No. No. piece No. part No. N°d Detail - No. No. da pedido
15.0036.120	06.0140.000	15.0036.120	06.0140.000	15.0036.120	06.0140.000
19.0030.252	15.0030.150 15.0030.134	19.0030.252	15.0030.150 15.0030.134	19.0030.252	15.0030.150 15.0030.134
48.2252.000	01.3017.000	48.2252.000	01.3017.000	48.2252.000	01.3017.000
5.0036.173	5.0036.437	5.0036.173	5.0036.437	5.0036.173	5.0036.437
21.3519.000	01.4107.000	21.3519.000	01.4107.000	21.3519.000	01.4107.000
01.0510.000	06.4152.000	01.0510.000	06.4152.000	01.0510.000	06.4152.000
01.4048.000	00.1254.000	01.4048.000	00.1254.000	01.4048.000	00.1254.000
04.0605.000	08.4101.000	04.0605.000	08.4101.000	04.0605.000	08.4101.000
06.2510.000	01.3570.000	06.2510.000	01.3570.000	06.2510.000	01.3570.000
10.0036.300	15.0036.166	10.0036.300	15.0036.166	10.0036.300	15.0036.166
06.2097.010	06.2058.920	06.2097.010	06.2058.920	06.2097.010	06.2058.920
15.0036.185	07.0329.070	15.0036.185	07.0329.070	15.0036.185	07.0329.070
05.2652.000	06.2145.000	05.2652.000	06.2145.000	05.2652.000	06.2145.000
06.2488.000	05.0146.000 05.0145.040	06.2488.000	05.0146.000 05.0145.040	06.2488.000	05.0146.000 05.0145.040
5.0036.124	5.0036.180	5.0036.124	5.0036.180	5.0036.124	5.0036.180
01.0901.050	15.0036.100	01.0901.050	15.0036.100	01.0901.050	15.0036.100
04.0813.080	15.0036.140	04.0813.080	15.0036.140	04.0813.080	15.0036.140

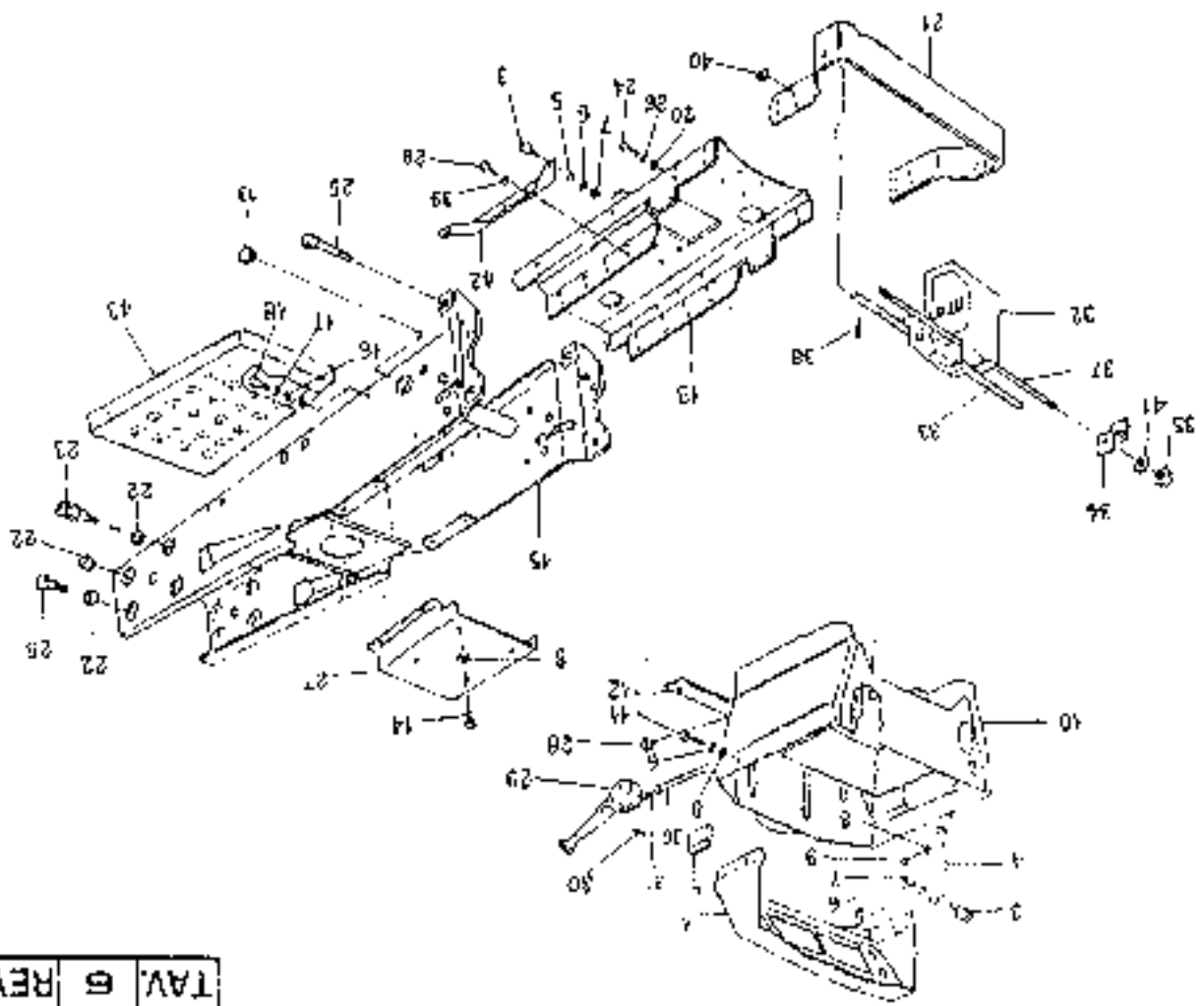

TAV. 5 REV.

MOD.18/20/22-3W



A REQUEST  
SPEL DRYLAND

Indicaciones de validación  
Signification de validat  
Gütelisvermerk  
Indicaciones de validat

No. pieza	No. de instrucciones	Part. No.	No. de comando	No. de pedido	No. de instrucciones	No. de pieza	No. de instrucciones	No. de pieza
1	15.0036.041	80.1094.000	15.0036.040	80.1094.000	15.0036.040	80.1094.000	15.0036.040	80.1094.000
2	84.0685.000	86.2601.000	15.0036.040	86.2601.000	15.0036.040	86.2601.000	15.0036.040	86.2601.000
3	84.0641.060	86.2601.000	15.0036.040	86.2601.000	15.0036.040	86.2601.000	15.0036.040	86.2601.000
4	86.2555.000	86.2555.000	15.0036.040	86.2555.000	15.0036.040	86.2555.000	15.0036.040	86.2555.000
5	80.4051.000	81.1146.000	81.1146.000	81.1146.000	81.1146.000	81.1146.000	81.1146.000	81.1146.000
6	84.0825.050	84.0809.020	84.0809.020	84.0809.020	84.0809.020	84.0809.020	84.0809.020	84.0809.020
7	15.0036.119	80.1128.000	80.1128.000	80.1128.000	80.1128.000	80.1128.000	80.1128.000	80.1128.000
8	84.0993.000	15.0036.364	15.0036.364	15.0036.364	15.0036.364	15.0036.364	15.0036.364	15.0036.364
9	80.4052.000	81.2554.000	81.2554.000	81.2554.000	81.2554.000	81.2554.000	81.2554.000	81.2554.000
10	15.0036.342	81.0505.000	81.0505.000	81.0505.000	81.0505.000	81.0505.000	81.0505.000	81.0505.000
11	15.0036.342	86.3493.000	86.3493.000	86.3493.000	86.3493.000	86.3493.000	86.3493.000	86.3493.000
12	84.0685.000	84.1807.000	84.1807.000	84.1807.000	84.1807.000	84.1807.000	84.1807.000	84.1807.000
13	84.3813.000	84.3755.000	84.3755.000	84.3755.000	84.3755.000	84.3755.000	84.3755.000	84.3755.000
14	83.1323.000	84.3755.000	84.3755.000	84.3755.000	84.3755.000	84.3755.000	84.3755.000	84.3755.000

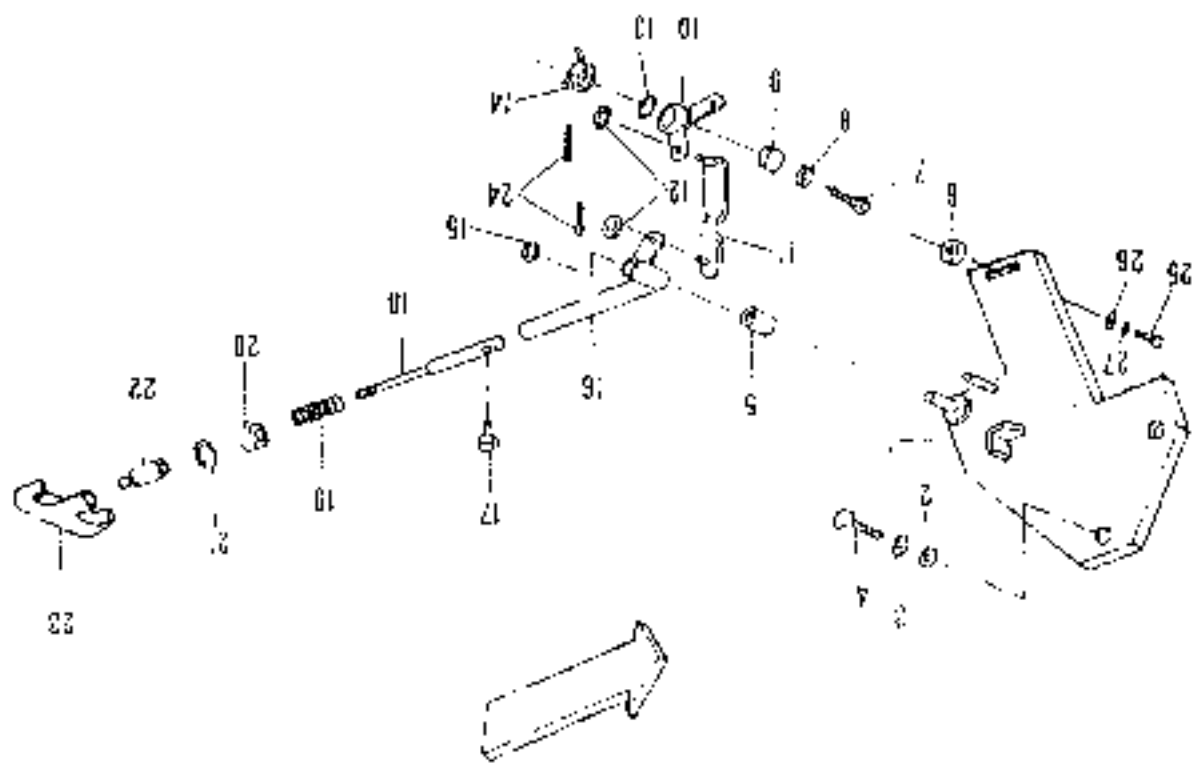

MOD.18/20/22-3W  
TAV.6/1REV.



No. parte	No. parte	No. di riferimento	No. parte	No. parte	No. parte
1	2	3	4	5	6
26.654.000	01.475.000	06.1342.000	06.1324.000	07.4627.000	07.4731.000
7	8	9	10	11	12
06.1408.000	06.1408.000	06.1408.000	06.1408.000	06.1408.000	06.1408.000
13	14	15	16	17	18
04.2759.000	15.0030.267	15.0030.265	08.2901.000	07.4627.000	00.2443.010



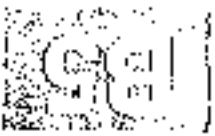

MINISTÈRE DE LA SANTÉ  
 DÉPARTEMENT DE LA SANTÉ  
 BUREAU DE LA SANTÉ  
 100, RUE DE LA SANTÉ  
 MONTRÉAL, QUÉBEC H3T 1M1

REGISTRATION DE LA SANTÉ  
 DÉPARTEMENT DE LA SANTÉ  
 100, RUE DE LA SANTÉ  
 MONTRÉAL, QUÉBEC H3T 1M1

NO DE PATIENT	NO DE CONSULTATION	NO DE PRESCRIPTION	NO DE PRESCRIPTION	NO DE PRESCRIPTION	NO DE PRESCRIPTION	NO DE PRESCRIPTION	NO DE PRESCRIPTION
1	1	1	1	1	1	1	1
2	2	2	2	2	2	2	2
3	3	3	3	3	3	3	3
4	4	4	4	4	4	4	4
5	5	5	5	5	5	5	5
6	6	6	6	6	6	6	6
7	7	7	7	7	7	7	7
8	8	8	8	8	8	8	8
9	9	9	9	9	9	9	9
10	10	10	10	10	10	10	10
11	11	11	11	11	11	11	11
12	12	12	12	12	12	12	12
13	13	13	13	13	13	13	13
14	14	14	14	14	14	14	14
15	15	15	15	15	15	15	15
16	16	16	16	16	16	16	16
17	17	17	17	17	17	17	17
18	18	18	18	18	18	18	18
19	19	19	19	19	19	19	19
20	20	20	20	20	20	20	20
21	21	21	21	21	21	21	21
22	22	22	22	22	22	22	22
23	23	23	23	23	23	23	23
24	24	24	24	24	24	24	24
25	25	25	25	25	25	25	25
26	26	26	26	26	26	26	26
27	27	27	27	27	27	27	27
28	28	28	28	28	28	28	28
29	29	29	29	29	29	29	29
30	30	30	30	30	30	30	30

MINISTÈRE DE LA SANTÉ  
 DÉPARTEMENT DE LA SANTÉ  
 BUREAU DE LA SANTÉ  
 100, RUE DE LA SANTÉ  
 MONTRÉAL, QUÉBEC H3T 1M1



MINISTÈRE DE LA SANTÉ  
 DÉPARTEMENT DE LA SANTÉ  
 BUREAU DE LA SANTÉ  
 100, RUE DE LA SANTÉ  
 MONTRÉAL, QUÉBEC H3T 1M1

Legende des symboles  
 Symbole de la valeur  
 Designation de la valeur  
 Designation de la valeur  
 Designation de la valeur

Double action  
 Double action  
 Double action  
 Double action  
 Double action

**B6**

No. piece	No. piece	No. de commande	No. de commande	No. de commande	No. de commande
1	1	01.2561.050	01.2561.050	01.2561.050	01.2561.050
2	2	01.0120.040	01.0120.040	01.0120.040	01.0120.040
3	3	01.8160.090	01.8160.090	01.8160.090	01.8160.090
4	4	01.8160.050	01.8160.050	01.8160.050	01.8160.050
5	5	01.8160.050	01.8160.050	01.8160.050	01.8160.050
6	6	01.9160.000	01.9160.000	01.9160.000	01.9160.000
7	7	15.0010.100	15.0010.100	15.0010.100	15.0010.100
8	8	15.0010.100	15.0010.100	15.0010.100	15.0010.100
9	9	15.0010.110	15.0010.110	15.0010.110	15.0010.110
10	10	01.0816.010	01.0816.010	01.0816.010	01.0816.010
11	11	15.0010.050	15.0010.050	15.0010.050	15.0010.050
12	12	15.0010.110	15.0010.110	15.0010.110	15.0010.110
13	13	01.0750.000	01.0750.000	01.0750.000	01.0750.000
14	14	01.4607.000	01.4607.000	01.4607.000	01.4607.000
15	15	01.2630.000	01.2630.000	01.2630.000	01.2630.000
16	16	01.9100.060	01.9100.060	01.9100.060	01.9100.060
17	17	01.9100.070	01.9100.070	01.9100.070	01.9100.070

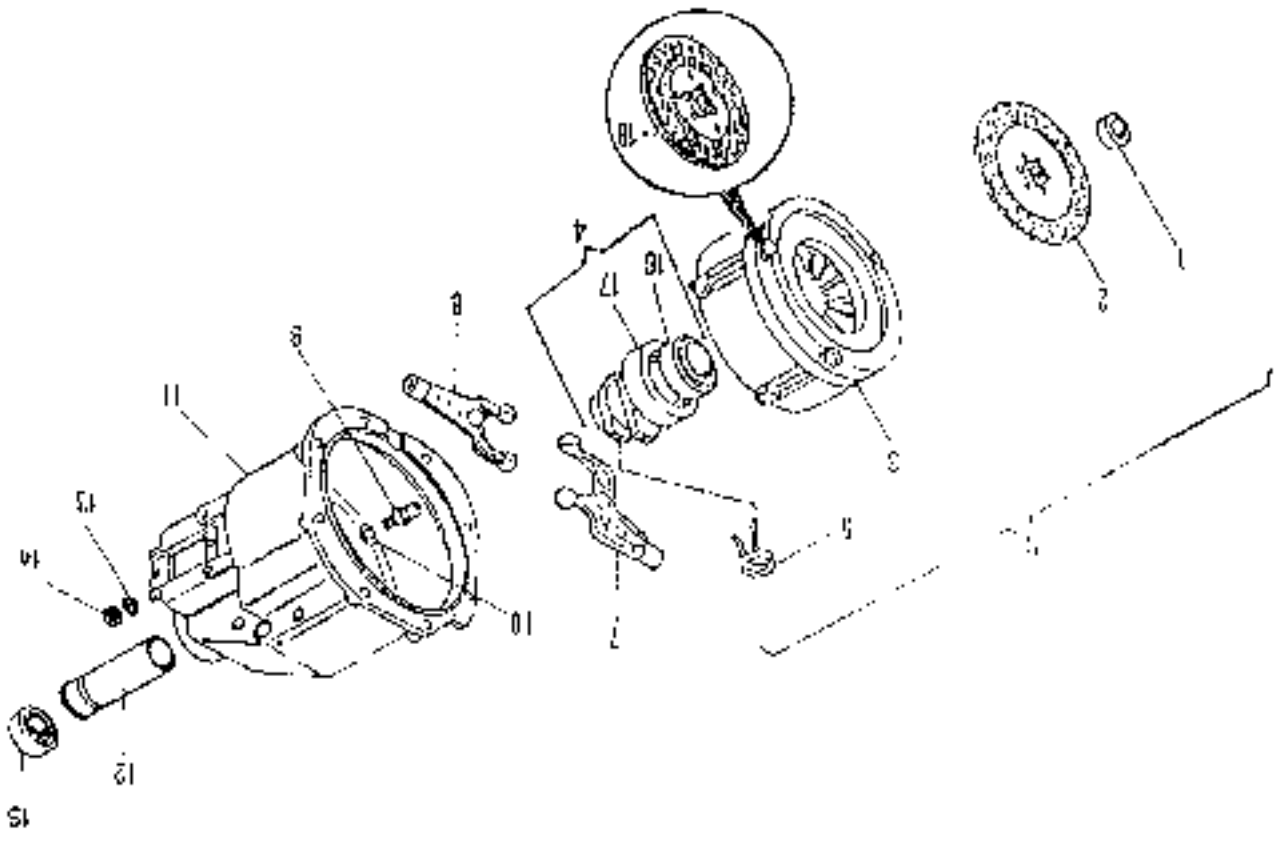

MOD.18/20/22-3W  
 TAV. 9 REV.





No. pieza	Part No.	No. de compra	Distal - M.	No. de pedido	No. pieza	Part No.	No. de compra	Distal - M.	No. de pedido	No. pieza	Part No.	No. de compra	Distal - M.	No. de pedido
1	45.0006.481				12	45.0006.481			45.0006.481					
2	86.7407.000					86.7407.000			86.7407.000					
3	45.0006.204					45.0006.204			45.0006.204					
4	45.0006.476					45.0006.476			45.0006.476					
5	45.0006.054					45.0006.054			45.0006.054					
6	49.0005.055					49.0005.055			49.0005.055					
7	45.0006.032					45.0006.032			45.0006.032					
8	85.2612.000					85.2612.000			85.2612.000					
9	86.2612.010					86.2612.010			86.2612.010					
10	85.3521.000					85.3521.000			85.3521.000					
11	85.2164.000					85.2164.000			85.2164.000					
12	45.0006.125					45.0006.125			45.0006.125					
13	85.4944.000					85.4944.000			85.4944.000					
14	85.2135.050					85.2135.050			85.2135.050					
15	45.0006.203					45.0006.203			45.0006.203					
16	84.3801.000					84.3801.000			84.3801.000					

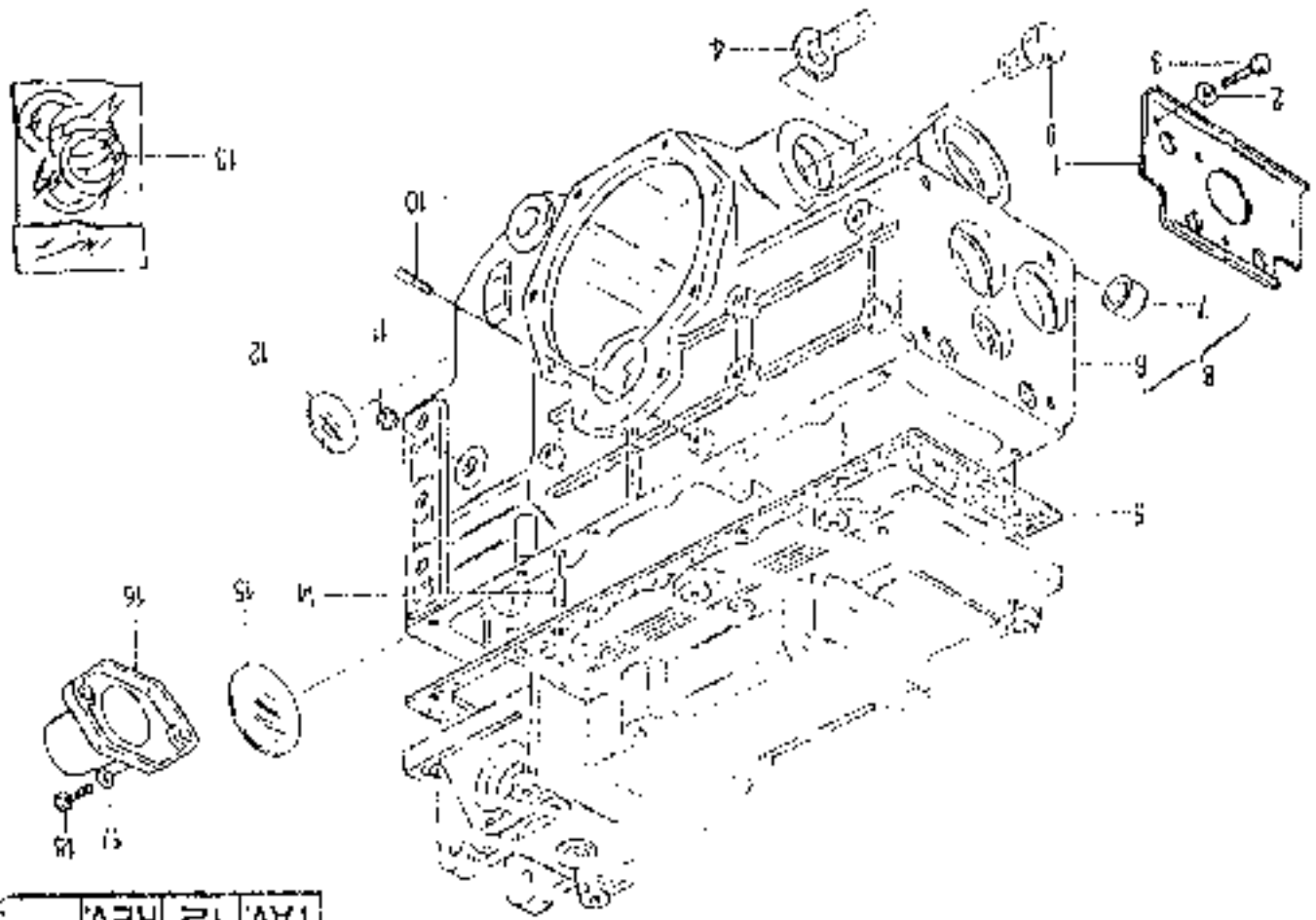



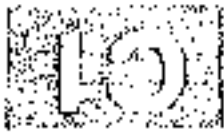

No. parti	No. parti	No. parti	No. parti	No. parti	No. parti
17	17	17	17	17	17
18	18	18	18	18	18
19	19	19	19	19	19
20	20	20	20	20	20
21	21	21	21	21	21
22	22	22	22	22	22
23	23	23	23	23	23
24	24	24	24	24	24
25	25	25	25	25	25
26	26	26	26	26	26
27	27	27	27	27	27
28	28	28	28	28	28
29	29	29	29	29	29
30	30	30	30	30	30
31	31	31	31	31	31
32	32	32	32	32	32
33	33	33	33	33	33
34	34	34	34	34	34
35	35	35	35	35	35
36	36	36	36	36	36
37	37	37	37	37	37
38	38	38	38	38	38
39	39	39	39	39	39
40	40	40	40	40	40
41	41	41	41	41	41
42	42	42	42	42	42
43	43	43	43	43	43
44	44	44	44	44	44
45	45	45	45	45	45
46	46	46	46	46	46
47	47	47	47	47	47
48	48	48	48	48	48
49	49	49	49	49	49
50	50	50	50	50	50
51	51	51	51	51	51
52	52	52	52	52	52
53	53	53	53	53	53
54	54	54	54	54	54
55	55	55	55	55	55
56	56	56	56	56	56
57	57	57	57	57	57
58	58	58	58	58	58
59	59	59	59	59	59
60	60	60	60	60	60
61	61	61	61	61	61
62	62	62	62	62	62
63	63	63	63	63	63
64	64	64	64	64	64
65	65	65	65	65	65
66	66	66	66	66	66
67	67	67	67	67	67
68	68	68	68	68	68
69	69	69	69	69	69
70	70	70	70	70	70
71	71	71	71	71	71
72	72	72	72	72	72
73	73	73	73	73	73
74	74	74	74	74	74
75	75	75	75	75	75
76	76	76	76	76	76
77	77	77	77	77	77
78	78	78	78	78	78
79	79	79	79	79	79
80	80	80	80	80	80
81	81	81	81	81	81
82	82	82	82	82	82
83	83	83	83	83	83
84	84	84	84	84	84
85	85	85	85	85	85
86	86	86	86	86	86
87	87	87	87	87	87
88	88	88	88	88	88
89	89	89	89	89	89
90	90	90	90	90	90
91	91	91	91	91	91
92	92	92	92	92	92
93	93	93	93	93	93
94	94	94	94	94	94
95	95	95	95	95	95
96	96	96	96	96	96
97	97	97	97	97	97
98	98	98	98	98	98
99	99	99	99	99	99
100	100	100	100	100	100

100  
 99  
 98  
 97  
 96  
 95  
 94  
 93  
 92  
 91  
 90  
 89  
 88  
 87  
 86  
 85  
 84  
 83  
 82  
 81  
 80  
 79  
 78  
 77  
 76  
 75  
 74  
 73  
 72  
 71  
 70  
 69  
 68  
 67  
 66  
 65  
 64  
 63  
 62  
 61  
 60  
 59  
 58  
 57  
 56  
 55  
 54  
 53  
 52  
 51  
 50  
 49  
 48  
 47  
 46  
 45  
 44  
 43  
 42  
 41  
 40  
 39  
 38  
 37  
 36  
 35  
 34  
 33  
 32  
 31  
 30  
 29  
 28  
 27  
 26  
 25  
 24  
 23  
 22  
 21  
 20  
 19  
 18  
 17  
 16  
 15  
 14  
 13  
 12  
 11  
 10  
 9  
 8  
 7  
 6  
 5  
 4  
 3  
 2  
 1

100  
 99  
 98  
 97  
 96  
 95  
 94  
 93  
 92  
 91  
 90  
 89  
 88  
 87  
 86  
 85  
 84  
 83  
 82  
 81  
 80  
 79  
 78  
 77  
 76  
 75  
 74  
 73  
 72  
 71  
 70  
 69  
 68  
 67  
 66  
 65  
 64  
 63  
 62  
 61  
 60  
 59  
 58  
 57  
 56  
 55  
 54  
 53  
 52  
 51  
 50  
 49  
 48  
 47  
 46  
 45  
 44  
 43  
 42  
 41  
 40  
 39  
 38  
 37  
 36  
 35  
 34  
 33  
 32  
 31  
 30  
 29  
 28  
 27  
 26  
 25  
 24  
 23  
 22  
 21  
 20  
 19  
 18  
 17  
 16  
 15  
 14  
 13  
 12  
 11  
 10  
 9  
 8  
 7  
 6  
 5  
 4  
 3  
 2  
 1



Separación de válvula  
 Sig. instalaciones de vapor  
 Estructuras y/o  
 Indicaciones de válvulas

No. pedido	No. pieza	No. plano	No. pieza	No. di. ordinales	No. pieza	No. di. ordinales
1	80.0517.000		10	15.0006.1 P. V		
2	80.1185.000		15	80.1182.000		
3	80.1422.000		20	80.1180.000		
4	81.2652.000		21	81.2145.000		
5	84.4210.000		22	15.0006.170	X	
6	84.2890.000		23	01.2504.000		
7	15.0000.170		24	15.0010.113		
8	84.4370.010		25	85.2195.050		
9	80.1229.000		26	05.2170.000		
10	15.0006.170	X	27	80.2123.010		
11	15.0006.470					
12	84.4446.000					
13	15.0000.177	X				
14	04.4444.000					
15	15.0000.204	X				
16	81.2700.020					
17						
18						
19						

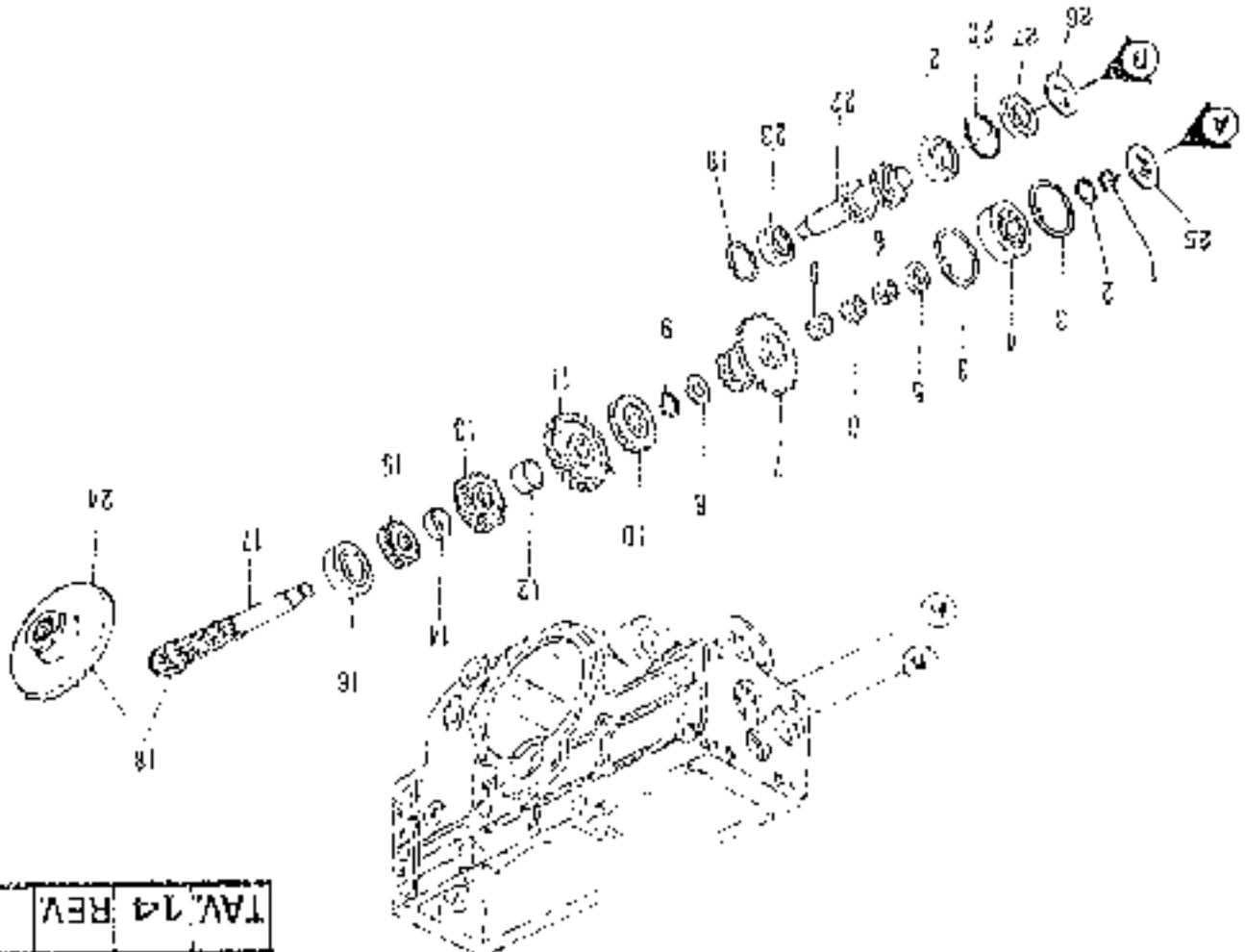

TAV. 14 REV.

MOD. 18/20/22.34

Segnalation of validite  
 Signification de validite  
 Gofly avtorizata  
 Indications de validite

04

No. parte	No. parte	No. parte	No. parte	No. parte	No. parte	No. parte	No. parte	No. parte	No. parte
17	17	17	17	17	17	17	17	17	17
18	18	18	18	18	18	18	18	18	18
19	19	19	19	19	19	19	19	19	19
20	20	20	20	20	20	20	20	20	20
21	21	21	21	21	21	21	21	21	21
22	22	22	22	22	22	22	22	22	22
23	23	23	23	23	23	23	23	23	23
24	24	24	24	24	24	24	24	24	24
25	25	25	25	25	25	25	25	25	25
26	26	26	26	26	26	26	26	26	26
27	27	27	27	27	27	27	27	27	27
28	28	28	28	28	28	28	28	28	28
29	29	29	29	29	29	29	29	29	29
30	30	30	30	30	30	30	30	30	30
31	31	31	31	31	31	31	31	31	31
32	32	32	32	32	32	32	32	32	32
33	33	33	33	33	33	33	33	33	33
34	34	34	34	34	34	34	34	34	34
35	35	35	35	35	35	35	35	35	35
36	36	36	36	36	36	36	36	36	36
37	37	37	37	37	37	37	37	37	37
38	38	38	38	38	38	38	38	38	38
39	39	39	39	39	39	39	39	39	39
40	40	40	40	40	40	40	40	40	40
41	41	41	41	41	41	41	41	41	41
42	42	42	42	42	42	42	42	42	42
43	43	43	43	43	43	43	43	43	43
44	44	44	44	44	44	44	44	44	44
45	45	45	45	45	45	45	45	45	45
46	46	46	46	46	46	46	46	46	46
47	47	47	47	47	47	47	47	47	47
48	48	48	48	48	48	48	48	48	48
49	49	49	49	49	49	49	49	49	49
50	50	50	50	50	50	50	50	50	50
51	51	51	51	51	51	51	51	51	51
52	52	52	52	52	52	52	52	52	52
53	53	53	53	53	53	53	53	53	53
54	54	54	54	54	54	54	54	54	54
55	55	55	55	55	55	55	55	55	55
56	56	56	56	56	56	56	56	56	56
57	57	57	57	57	57	57	57	57	57
58	58	58	58	58	58	58	58	58	58
59	59	59	59	59	59	59	59	59	59
60	60	60	60	60	60	60	60	60	60
61	61	61	61	61	61	61	61	61	61
62	62	62	62	62	62	62	62	62	62
63	63	63	63	63	63	63	63	63	63
64	64	64	64	64	64	64	64	64	64
65	65	65	65	65	65	65	65	65	65
66	66	66	66	66	66	66	66	66	66
67	67	67	67	67	67	67	67	67	67
68	68	68	68	68	68	68	68	68	68
69	69	69	69	69	69	69	69	69	69
70	70	70	70	70	70	70	70	70	70
71	71	71	71	71	71	71	71	71	71
72	72	72	72	72	72	72	72	72	72
73	73	73	73	73	73	73	73	73	73
74	74	74	74	74	74	74	74	74	74
75	75	75	75	75	75	75	75	75	75
76	76	76	76	76	76	76	76	76	76
77	77	77	77	77	77	77	77	77	77
78	78	78	78	78	78	78	78	78	78
79	79	79	79	79	79	79	79	79	79
80	80	80	80	80	80	80	80	80	80
81	81	81	81	81	81	81	81	81	81
82	82	82	82	82	82	82	82	82	82
83	83	83	83	83	83	83	83	83	83
84	84	84	84	84	84	84	84	84	84
85	85	85	85	85	85	85	85	85	85
86	86	86	86	86	86	86	86	86	86
87	87	87	87	87	87	87	87	87	87
88	88	88	88	88	88	88	88	88	88
89	89	89	89	89	89	89	89	89	89
90	90	90	90	90	90	90	90	90	90
91	91	91	91	91	91	91	91	91	91
92	92	92	92	92	92	92	92	92	92
93	93	93	93	93	93	93	93	93	93
94	94	94	94	94	94	94	94	94	94
95	95	95	95	95	95	95	95	95	95
96	96	96	96	96	96	96	96	96	96
97	97	97	97	97	97	97	97	97	97
98	98	98	98	98	98	98	98	98	98
99	99	99	99	99	99	99	99	99	99
100	100	100	100	100	100	100	100	100	100

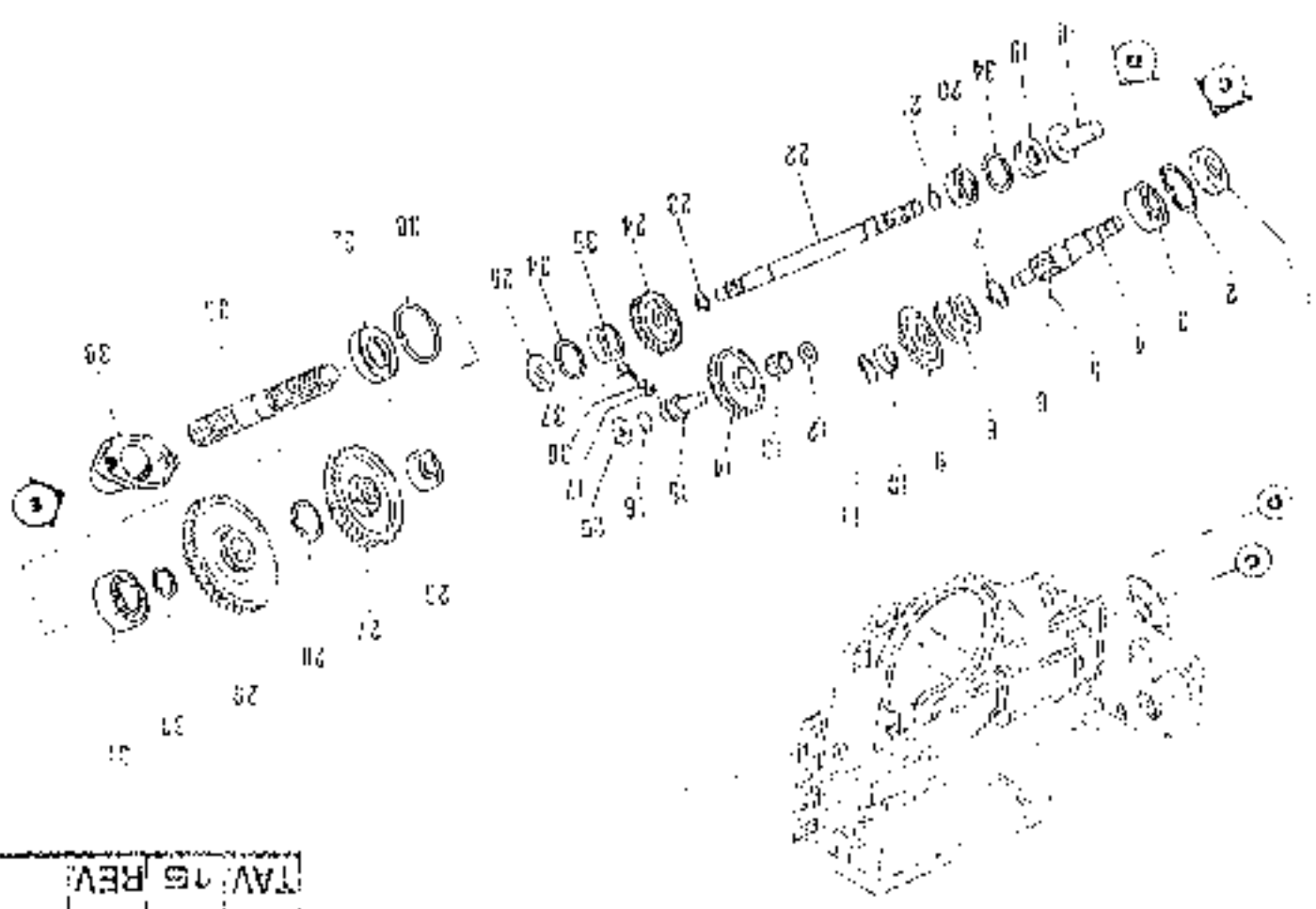

MON.18/20/22-3M  
 TAV.15 REV.

Siglação n.º valvula  
 Designação de valvula  
 Gührke's vermerk  
 Indicações de valvula

Trizono ranhoca  
 Single plate clutch  
 Klotzschke Kupplung  
 Engague monodisco

Senza superdiscatore  
 Without gear splitter  
 Sans supervariator



No. pezzo	No. piece	No. di ordinazione	No. piece	No. piece	No. di ordinazione
1	1	60 2177 010	18	18	61 2007 000
2	2	60 1241 000	19	19	60 1400 000
3	3	60 1422 000	20	20	64 4534 000
4	4	18 0007 000	21	21	61 8521 000
5	5	11 2750 000	22	22	61 0058 000
6	6	15 0006 000	23	23	15 0002 000
7	7	65 2707 000	24	24	15 0009 010
8	8	10 1300 000	25	25	15 0006 010
9	9	81 2640 000	26	26	11 2749 000
10	10	15 0006 000	27	27	90 2104 000
11	11	66 4200 000	28	28	63 4050 000
12	12	84 2021 000	29	29	84 4510 000
13	13	15 0006 000	30	30	61 2703 000
14	14	81 2529 000	31	31	81 2701 000
15	15	45 0006 010	32	32	45 0006 000
16	16	80 1264 000			
17	17	15 0006 010			

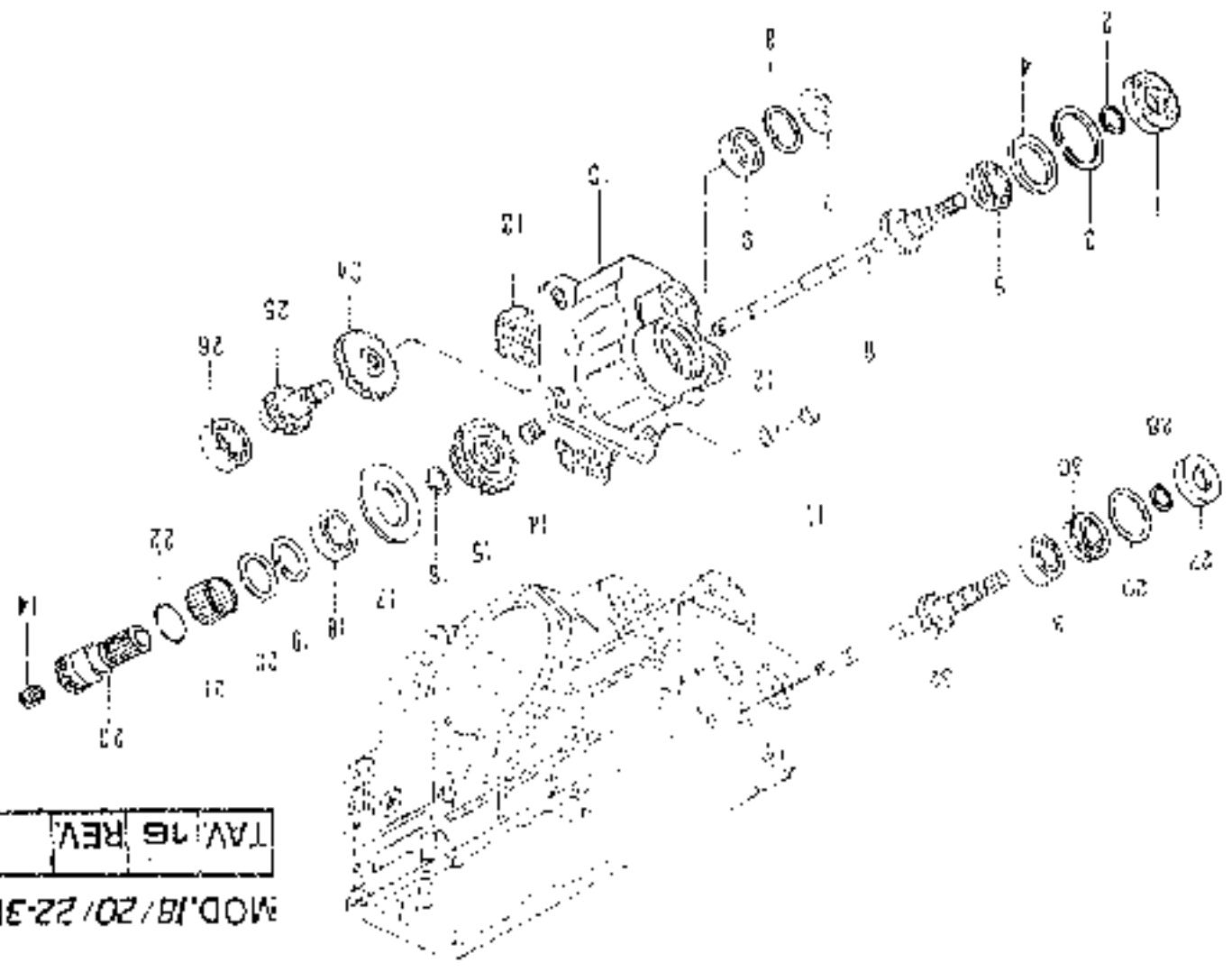

MOD.18/20/22-3W  
 TAV.16 REV.  
 1

Sequenzialni valilila  
 Sequenzialni de valilila  
 Gintigekvovovort  
 Inveccione de volilila

Dopla itziona  
 Itziona cuple  
 Eititvovvovvovvovvov  
 Zvevteevvovvovvovvov  
 Eititvovvovvovvovvovvov  
 Eititvovvovvovvovvovvov



No. itziona	No. itziona No. de itza	No. de itza	No. de itza	No. de itza	No. de itza	No. de itza	No. de itza
1	15.000.000	15.000.000	15.000.000	15.000.000	15.000.000	15.000.000	15.000.000
2	15.000.000	15.000.000	15.000.000	15.000.000	15.000.000	15.000.000	15.000.000
3	15.000.000	15.000.000	15.000.000	15.000.000	15.000.000	15.000.000	15.000.000
4	15.000.000	15.000.000	15.000.000	15.000.000	15.000.000	15.000.000	15.000.000
5	15.000.000	15.000.000	15.000.000	15.000.000	15.000.000	15.000.000	15.000.000
6	15.000.000	15.000.000	15.000.000	15.000.000	15.000.000	15.000.000	15.000.000
7	15.000.000	15.000.000	15.000.000	15.000.000	15.000.000	15.000.000	15.000.000
8	15.000.000	15.000.000	15.000.000	15.000.000	15.000.000	15.000.000	15.000.000
9	15.000.000	15.000.000	15.000.000	15.000.000	15.000.000	15.000.000	15.000.000
10	15.000.000	15.000.000	15.000.000	15.000.000	15.000.000	15.000.000	15.000.000
11	15.000.000	15.000.000	15.000.000	15.000.000	15.000.000	15.000.000	15.000.000
12	15.000.000	15.000.000	15.000.000	15.000.000	15.000.000	15.000.000	15.000.000
13	15.000.000	15.000.000	15.000.000	15.000.000	15.000.000	15.000.000	15.000.000
14	15.000.000	15.000.000	15.000.000	15.000.000	15.000.000	15.000.000	15.000.000
15	15.000.000	15.000.000	15.000.000	15.000.000	15.000.000	15.000.000	15.000.000
16	15.000.000	15.000.000	15.000.000	15.000.000	15.000.000	15.000.000	15.000.000
17	15.000.000	15.000.000	15.000.000	15.000.000	15.000.000	15.000.000	15.000.000

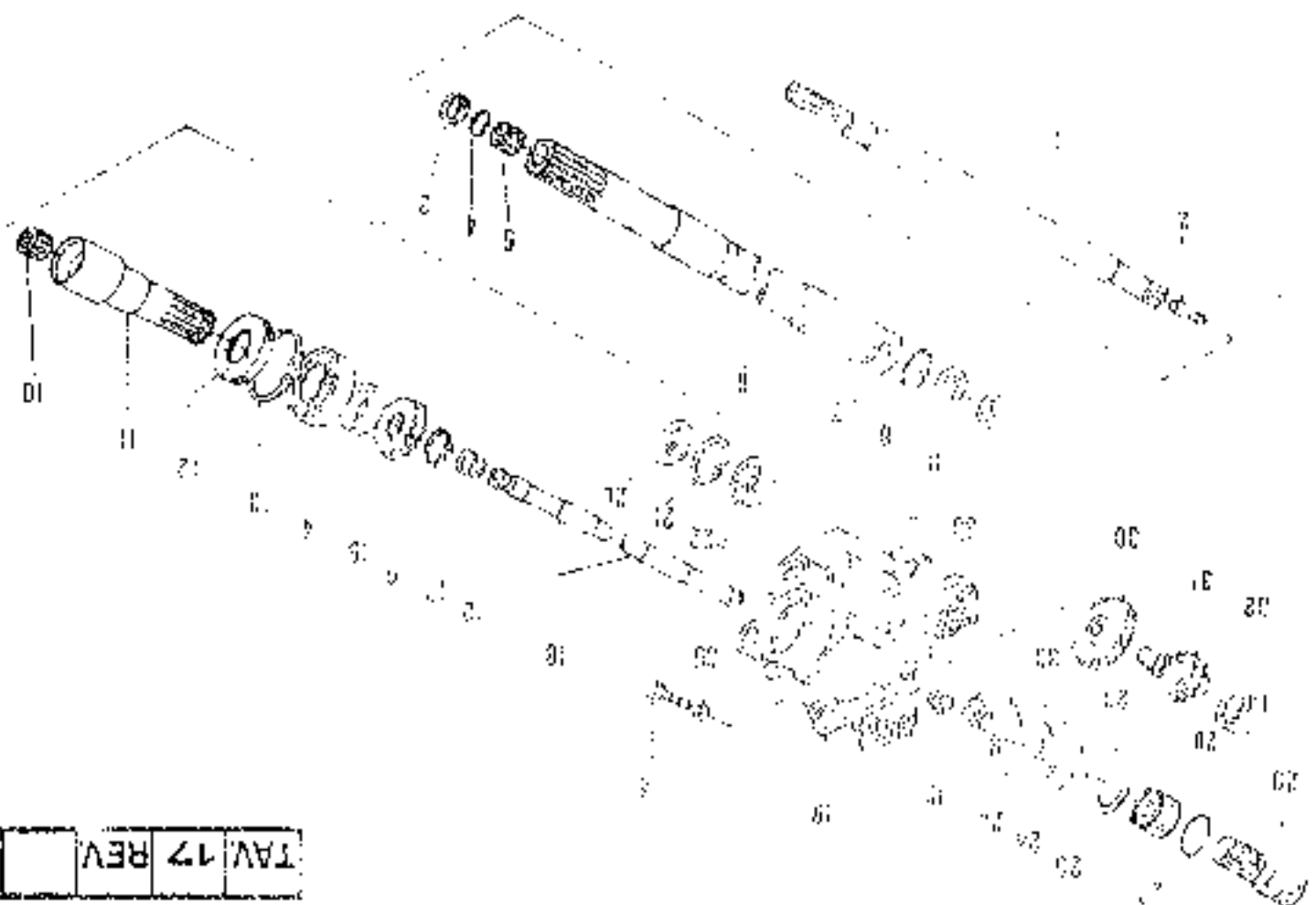

TAV. 17 REV.

MOD. 20/22-3W



资产	负债及所有者权益	资产	负债及所有者权益
流动资产	流动负债	流动资产	流动负债
货币资金	短期借款	货币资金	短期借款
应收账款	应付账款	应收账款	应付账款
预付款项	预收账款	预付款项	预收账款
其他应收款	应付职工薪酬	其他应收款	应付职工薪酬
存货	应交税费	存货	应交税费
流动资产合计	流动负债合计	流动资产合计	流动负债合计
非流动资产	非流动负债	非流动资产	非流动负债
长期股权投资	长期借款	长期股权投资	长期借款
固定资产	应付债券	固定资产	应付债券
无形资产	其他非流动负债	无形资产	其他非流动负债
非流动资产合计	非流动负债合计	非流动资产合计	非流动负债合计
资产总计	负债合计	资产总计	负债合计
	所有者权益		所有者权益
	实收资本		实收资本
	资本公积		资本公积
	盈余公积		盈余公积
	未分配利润		未分配利润
	所有者权益合计		所有者权益合计
	负债及所有者权益总计		负债及所有者权益总计

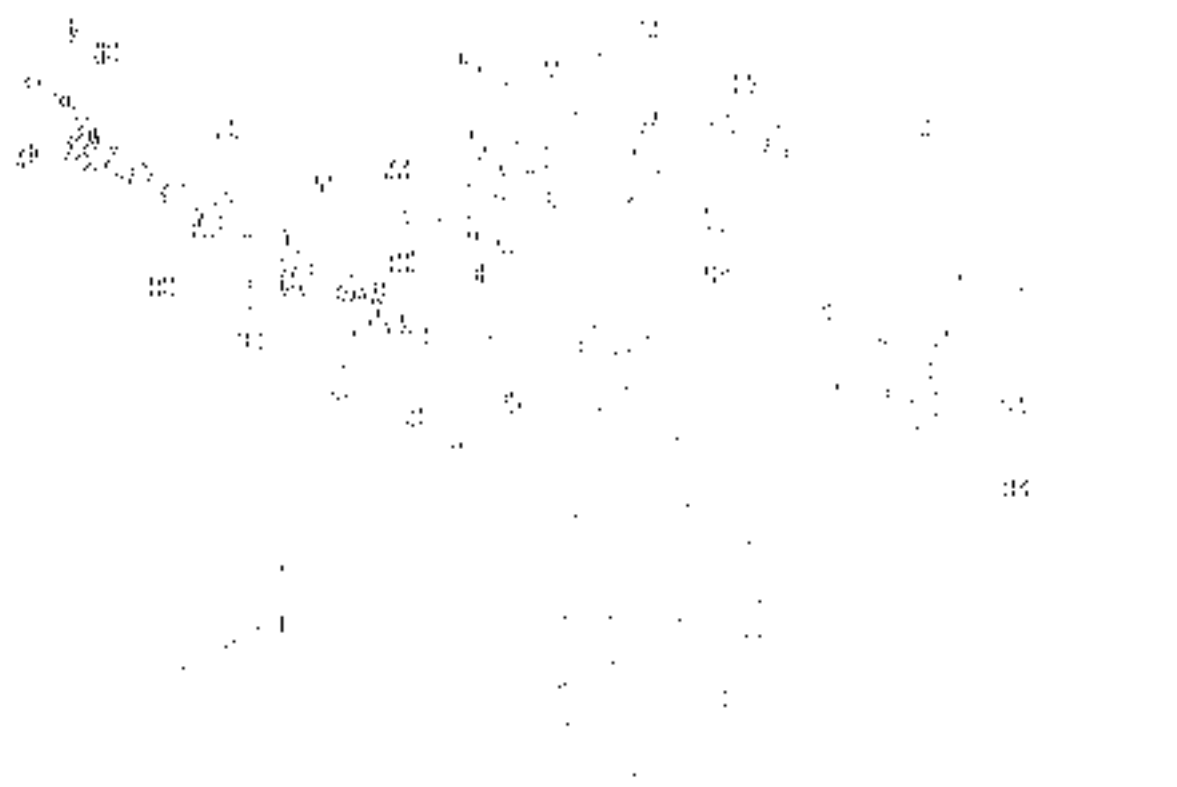



No. pezzo	No. disegno	No. pezzo	No. disegno	No. pezzo	No. disegno	No. pezzo	No. disegno
1	84.480.021	17	85.001.202	26	86.3412.070	30	86.3412.070
2	81.270.003	18	81.2832.000	31	85.004.103	31	85.004.103
3	19.0012.217	19	83.1625.000				
4	19.0012.113	20	80.2203.050				
5	84.2701.003	21	19.0011.104				
6	85.0103.020 3mm 0.2	22	84.3921.030				
7	84.460.040	23	06.4132.000				
8	85.0112.010 1mm 0.1	24	15.0011.054				
9	81.2572.000	25	19.0011.113				
10	15.0011.102	26	19.0012.202				
11	84.4528.000	27	80.1253.000				
12	81.2958.000	28	15.0011.104				
13	15.0011.105	29	85.0012.104				
14	15.0011.055	30	89.0012.047				
15	84.2755.000	31	89.0012.047				
16	86.2276.000	32	85.0012.034				
		33	89.0012.047				
		34	86.0010.105				
		35	86.0010.105				
		36	86.0010.105				
		37	86.0012.142				



Segretoria di edilizia  
 Segretoria di edilizia  
 Segretoria di edilizia  
 Segretoria di edilizia  
 Segretoria di edilizia





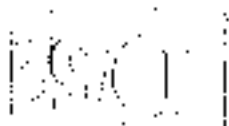

Year	Country	Value	Unit	Year	Country	Value	Unit
1950	U.S.	100	100	1950	U.S.	100	100
1951	U.S.	105	100	1951	U.S.	105	100
1952	U.S.	110	100	1952	U.S.	110	100
1953	U.S.	115	100	1953	U.S.	115	100
1954	U.S.	120	100	1954	U.S.	120	100
1955	U.S.	125	100	1955	U.S.	125	100
1956	U.S.	130	100	1956	U.S.	130	100
1957	U.S.	135	100	1957	U.S.	135	100
1958	U.S.	140	100	1958	U.S.	140	100
1959	U.S.	145	100	1959	U.S.	145	100
1960	U.S.	150	100	1960	U.S.	150	100
1961	U.S.	155	100	1961	U.S.	155	100
1962	U.S.	160	100	1962	U.S.	160	100
1963	U.S.	165	100	1963	U.S.	165	100
1964	U.S.	170	100	1964	U.S.	170	100
1965	U.S.	175	100	1965	U.S.	175	100
1966	U.S.	180	100	1966	U.S.	180	100
1967	U.S.	185	100	1967	U.S.	185	100
1968	U.S.	190	100	1968	U.S.	190	100
1969	U.S.	195	100	1969	U.S.	195	100
1970	U.S.	200	100	1970	U.S.	200	100
1971	U.S.	205	100	1971	U.S.	205	100
1972	U.S.	210	100	1972	U.S.	210	100
1973	U.S.	215	100	1973	U.S.	215	100
1974	U.S.	220	100	1974	U.S.	220	100
1975	U.S.	225	100	1975	U.S.	225	100
1976	U.S.	230	100	1976	U.S.	230	100
1977	U.S.	235	100	1977	U.S.	235	100
1978	U.S.	240	100	1978	U.S.	240	100
1979	U.S.	245	100	1979	U.S.	245	100
1980	U.S.	250	100	1980	U.S.	250	100
1981	U.S.	255	100	1981	U.S.	255	100
1982	U.S.	260	100	1982	U.S.	260	100
1983	U.S.	265	100	1983	U.S.	265	100
1984	U.S.	270	100	1984	U.S.	270	100
1985	U.S.	275	100	1985	U.S.	275	100
1986	U.S.	280	100	1986	U.S.	280	100
1987	U.S.	285	100	1987	U.S.	285	100
1988	U.S.	290	100	1988	U.S.	290	100
1989	U.S.	295	100	1989	U.S.	295	100
1990	U.S.	300	100	1990	U.S.	300	100
1991	U.S.	305	100	1991	U.S.	305	100
1992	U.S.	310	100	1992	U.S.	310	100
1993	U.S.	315	100	1993	U.S.	315	100
1994	U.S.	320	100	1994	U.S.	320	100
1995	U.S.	325	100	1995	U.S.	325	100
1996	U.S.	330	100	1996	U.S.	330	100
1997	U.S.	335	100	1997	U.S.	335	100
1998	U.S.	340	100	1998	U.S.	340	100
1999	U.S.	345	100	1999	U.S.	345	100
2000	U.S.	350	100	2000	U.S.	350	100
2001	U.S.	355	100	2001	U.S.	355	100
2002	U.S.	360	100	2002	U.S.	360	100
2003	U.S.	365	100	2003	U.S.	365	100
2004	U.S.	370	100	2004	U.S.	370	100
2005	U.S.	375	100	2005	U.S.	375	100
2006	U.S.	380	100	2006	U.S.	380	100
2007	U.S.	385	100	2007	U.S.	385	100
2008	U.S.	390	100	2008	U.S.	390	100
2009	U.S.	395	100	2009	U.S.	395	100
2010	U.S.	400	100	2010	U.S.	400	100
2011	U.S.	405	100	2011	U.S.	405	100
2012	U.S.	410	100	2012	U.S.	410	100
2013	U.S.	415	100	2013	U.S.	415	100
2014	U.S.	420	100	2014	U.S.	420	100
2015	U.S.	425	100	2015	U.S.	425	100
2016	U.S.	430	100	2016	U.S.	430	100
2017	U.S.	435	100	2017	U.S.	435	100
2018	U.S.	440	100	2018	U.S.	440	100
2019	U.S.	445	100	2019	U.S.	445	100
2020	U.S.	450	100	2020	U.S.	450	100
2021	U.S.	455	100	2021	U.S.	455	100
2022	U.S.	460	100	2022	U.S.	460	100
2023	U.S.	465	100	2023	U.S.	465	100
2024	U.S.	470	100	2024	U.S.	470	100
2025	U.S.	475	100	2025	U.S.	475	100
2026	U.S.	480	100	2026	U.S.	480	100
2027	U.S.	485	100	2027	U.S.	485	100
2028	U.S.	490	100	2028	U.S.	490	100
2029	U.S.	495	100	2029	U.S.	495	100
2030	U.S.	500	100	2030	U.S.	500	100

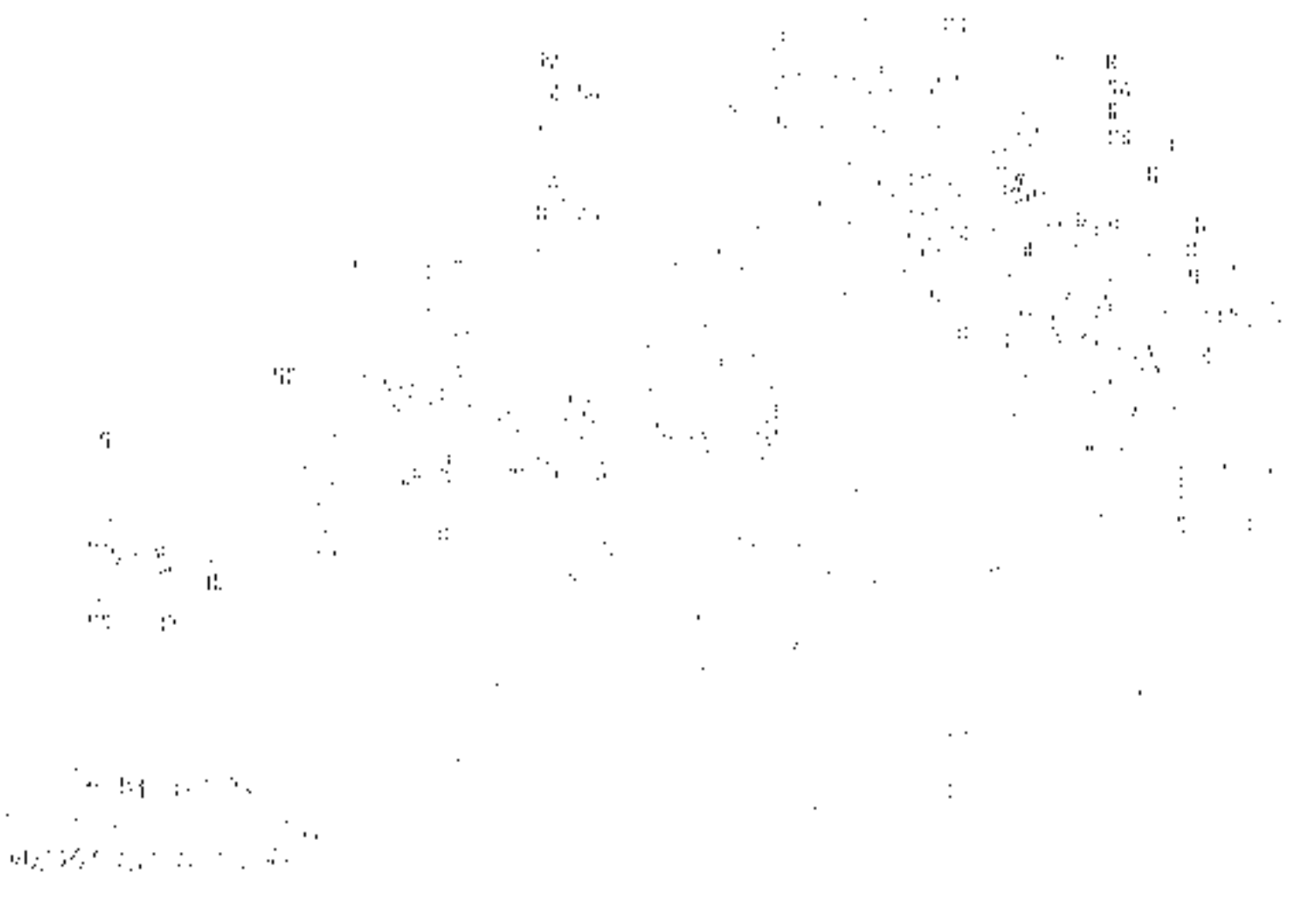



Signalization di validità  
 Validity signalization  
 Qualifications de validité  
 Indications de validité

No. pieza	No. part	No. di indirection	No. piece	No. part	No. di indirection	No. piece	No. part	No. di indirection	No. piece	No. part	No. di indirection
1	84.385.000		1	84.385.000		1	84.385.000		1	84.385.000	
2	15.0020.104		2	15.0020.100		2	15.0020.100		2	15.0020.100	
3	80.1166.000		3	80.1166.000		3	80.1166.000		3	80.1166.000	
4	15.0020.100		4	15.0020.100		4	15.0020.100		4	15.0020.100	
5	15.0020.100		5	15.0020.100		5	15.0020.100		5	15.0020.100	
6	01.0505.010		6	01.0505.010		6	01.0505.010		6	01.0505.010	
7	03.5523.050		7	03.5523.050		7	03.5523.050		7	03.5523.050	
8	15.0020.100		8	15.0020.100		8	15.0020.100		8	15.0020.100	
9	81.4501.000		9	81.4501.000		9	81.4501.000		9	81.4501.000	
10	86.0000.000		10	86.0000.000		10	86.0000.000		10	86.0000.000	
11	80.1130.000		11	80.1130.000		11	80.1130.000		11	80.1130.000	
12	16.0020.110		12	16.0020.110		12	16.0020.110		12	16.0020.110	
13	15.0020.101		13	15.0020.101		13	15.0020.101		13	15.0020.101	
14	08.0170.040		14	08.0170.040		14	08.0170.040		14	08.0170.040	
15	82.3070.010		15	82.3070.010		15	82.3070.010		15	82.3070.010	
16	84.3421.030		16	84.3421.030		16	84.3421.030		16	84.3421.030	
17	84.3421.030		17	84.3421.030		17	84.3421.030		17	84.3421.030	

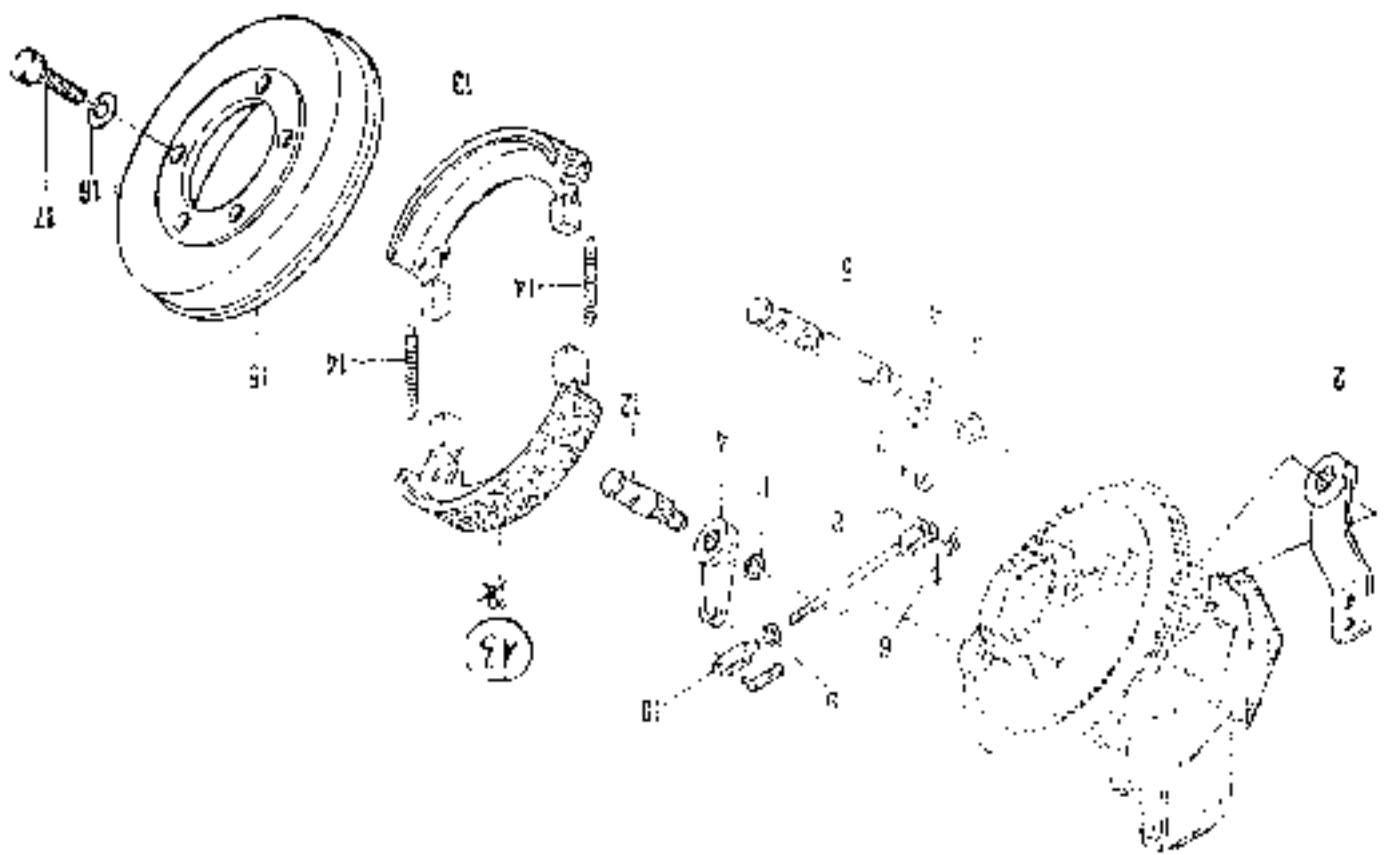



Con servidora a honra e provecho confor el  
 with after received with automatic control

Reglamento de visitas  
 Usage code  
 Significación de vedado  
 Organizaciones  
 Indices de vedado

2. con el equipo de  
 con standard after

No. de pieza	No. de articulo	No. de pieza	No. de articulo	No. de pieza	No. de articulo
1	502000000	18	150030183	1	502000000
2	502000000	19	150030183	2	502000000
3	502000000	20	150030183	3	502000000
4	502000000	21	150030183	4	502000000
5	502000000	22	150030183	5	502000000
6	502000000	23	150030183	6	502000000
7	502000000	24	150030183	7	502000000
8	502000000	25	150030183	8	502000000
9	502000000	26	150030183	9	502000000
10	502000000	27	150030183	10	502000000
11	502000000	28	150030183	11	502000000
12	502000000	29	150030183	12	502000000
13	502000000	30	150030183	13	502000000
14	502000000	31	150030183	14	502000000
15	502000000	32	150030183	15	502000000
16	502000000	33	150030183	16	502000000
17	502000000	34	150030183	17	502000000
18	502000000	35	150030183	18	502000000
19	502000000	36	150030183	19	502000000
20	502000000	37	150030183	20	502000000
21	502000000	38	150030183	21	502000000
22	502000000	39	150030183	22	502000000
23	502000000	40	150030183	23	502000000
24	502000000	41	150030183	24	502000000
25	502000000	42	150030183	25	502000000
26	502000000	43	150030183	26	502000000
27	502000000	44	150030183	27	502000000
28	502000000	45	150030183	28	502000000
29	502000000	46	150030183	29	502000000
30	502000000	47	150030183	30	502000000
31	502000000	48	150030183	31	502000000
32	502000000	49	150030183	32	502000000
33	502000000	50	150030183	33	502000000
34	502000000	51	150030183	34	502000000
35	502000000	52	150030183	35	502000000
36	502000000	53	150030183	36	502000000
37	502000000	54	150030183	37	502000000
38	502000000	55	150030183	38	502000000
39	502000000	56	150030183	39	502000000
40	502000000	57	150030183	40	502000000
41	502000000	58	150030183	41	502000000
42	502000000	59	150030183	42	502000000
43	502000000	60	150030183	43	502000000
44	502000000	61	150030183	44	502000000
45	502000000	62	150030183	45	502000000
46	502000000	63	150030183	46	502000000
47	502000000	64	150030183	47	502000000
48	502000000	65	150030183	48	502000000
49	502000000	66	150030183	49	502000000
50	502000000	67	150030183	50	502000000

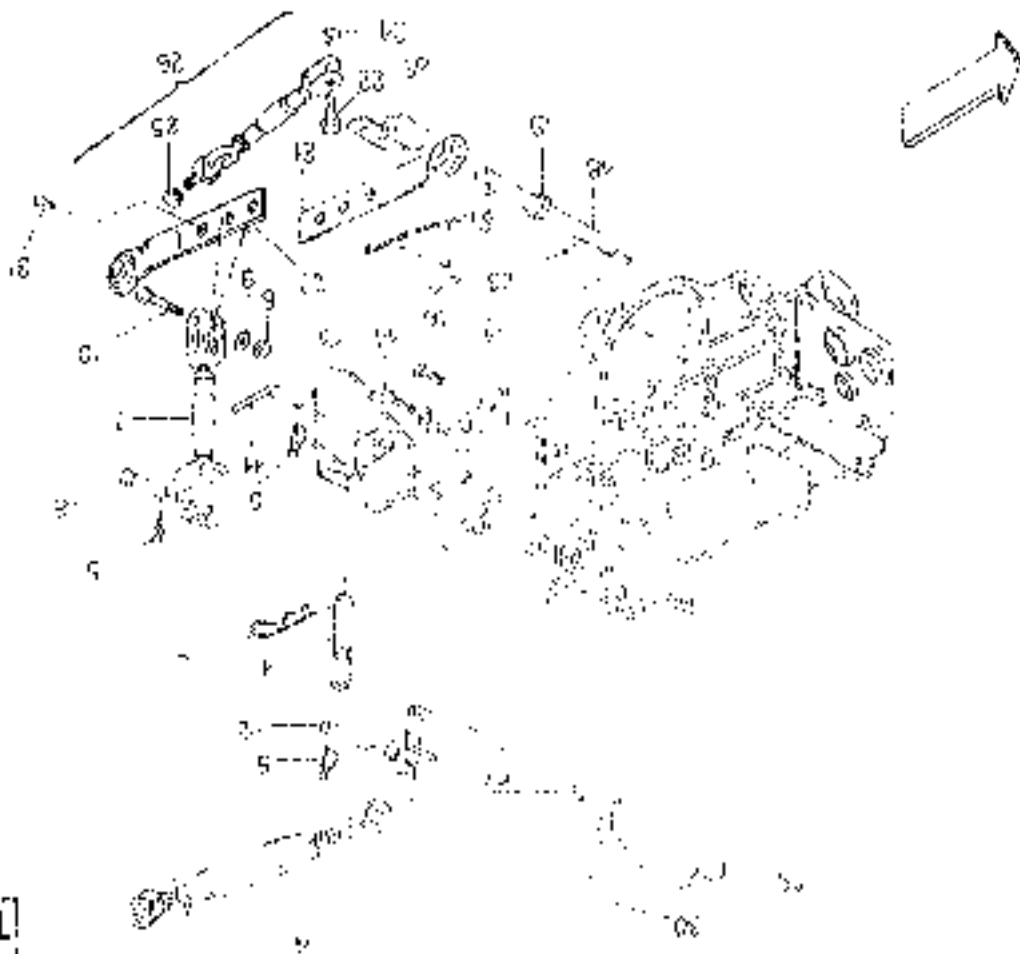

TAV 24 REV

MOD.18/20/22-3W

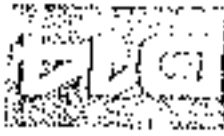

NATIONAL BUREAU OF ECONOMIC RESEARCH  
 79 JOURNAL OF POLITICAL ECONOMY  
 1971

Year	1960	1961	1962	1963	1964	1965	1966	1967	1968	1969	1970
Real GDP	100.0	100.0	100.0	100.0	100.0	100.0	100.0	100.0	100.0	100.0	100.0
Real GDP per capita	100.0	100.0	100.0	100.0	100.0	100.0	100.0	100.0	100.0	100.0	100.0
Real GDP growth rate		4.2	4.7	4.9	4.5	4.5	4.7	5.0	4.8	5.0	5.0
Real GDP per capita growth rate		2.7	2.9	3.0	2.8	2.8	2.9	3.0	2.9	3.0	3.0
Real GDP per capita growth rate (annualized)		2.7	2.9	3.0	2.8	2.8	2.9	3.0	2.9	3.0	3.0
Real GDP per capita growth rate (annualized)		2.7	2.9	3.0	2.8	2.8	2.9	3.0	2.9	3.0	3.0
Real GDP per capita growth rate (annualized)		2.7	2.9	3.0	2.8	2.8	2.9	3.0	2.9	3.0	3.0

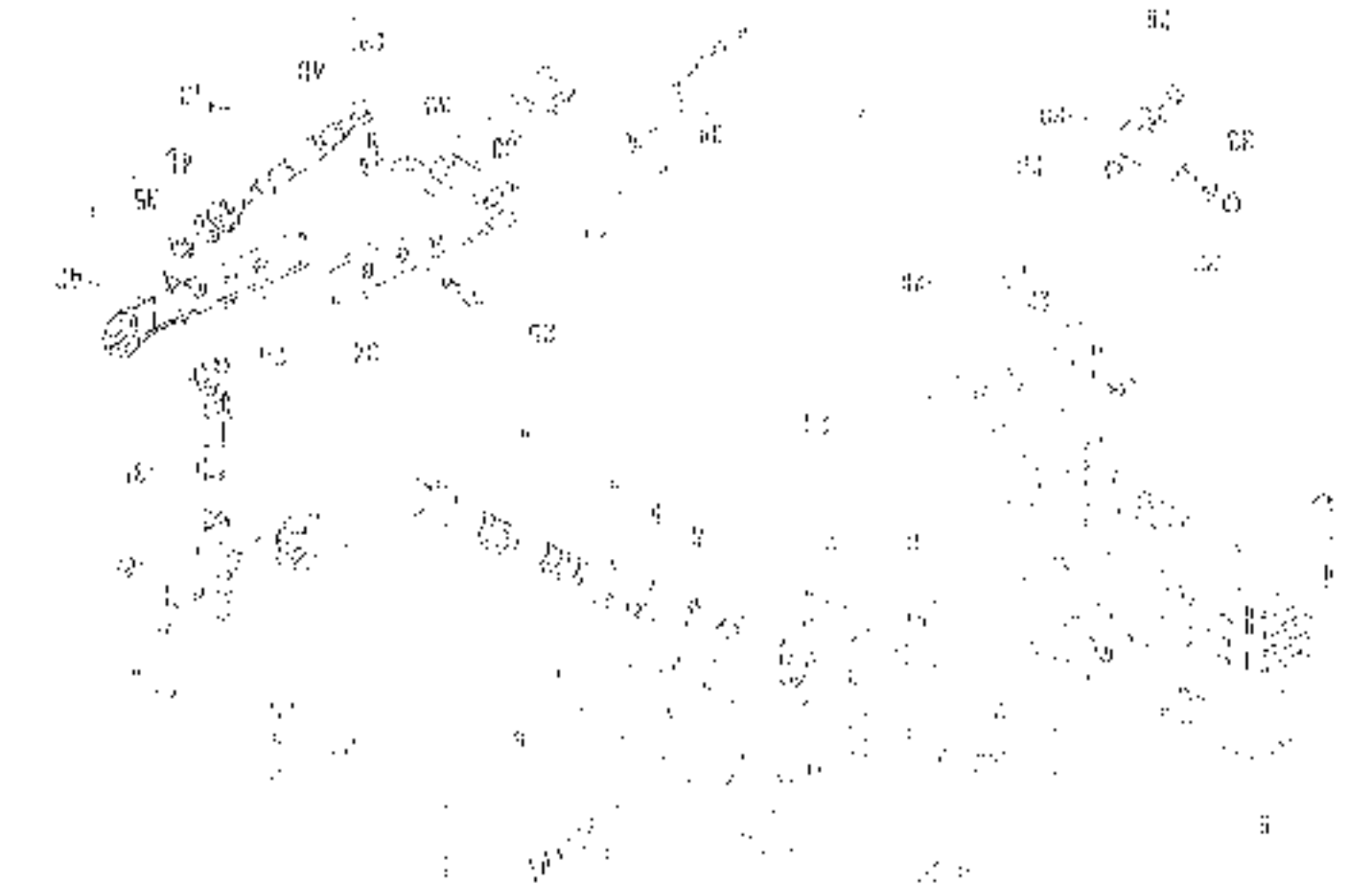

NATIONAL BUREAU OF ECONOMIC RESEARCH  
 79 JOURNAL OF POLITICAL ECONOMY  
 1971

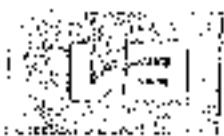

Lp. pozycji		Nazwa		Jednostka		Liczba	
Lp. pozycji		Nazwa		Jednostka		Liczba	
1	1	1	1	1	1	1	1
2	2	2	2	2	2	2	2
3	3	3	3	3	3	3	3
4	4	4	4	4	4	4	4
5	5	5	5	5	5	5	5
6	6	6	6	6	6	6	6
7	7	7	7	7	7	7	7
8	8	8	8	8	8	8	8
9	9	9	9	9	9	9	9
10	10	10	10	10	10	10	10
11	11	11	11	11	11	11	11
12	12	12	12	12	12	12	12
13	13	13	13	13	13	13	13
14	14	14	14	14	14	14	14
15	15	15	15	15	15	15	15
16	16	16	16	16	16	16	16
17	17	17	17	17	17	17	17
18	18	18	18	18	18	18	18
19	19	19	19	19	19	19	19
20	20	20	20	20	20	20	20
21	21	21	21	21	21	21	21
22	22	22	22	22	22	22	22
23	23	23	23	23	23	23	23
24	24	24	24	24	24	24	24
25	25	25	25	25	25	25	25
26	26	26	26	26	26	26	26
27	27	27	27	27	27	27	27
28	28	28	28	28	28	28	28
29	29	29	29	29	29	29	29
30	30	30	30	30	30	30	30
31	31	31	31	31	31	31	31
32	32	32	32	32	32	32	32
33	33	33	33	33	33	33	33
34	34	34	34	34	34	34	34
35	35	35	35	35	35	35	35
36	36	36	36	36	36	36	36
37	37	37	37	37	37	37	37
38	38	38	38	38	38	38	38
39	39	39	39	39	39	39	39
40	40	40	40	40	40	40	40
41	41	41	41	41	41	41	41
42	42	42	42	42	42	42	42
43	43	43	43	43	43	43	43
44	44	44	44	44	44	44	44
45	45	45	45	45	45	45	45
46	46	46	46	46	46	46	46
47	47	47	47	47	47	47	47
48	48	48	48	48	48	48	48
49	49	49	49	49	49	49	49
50	50	50	50	50	50	50	50
51	51	51	51	51	51	51	51
52	52	52	52	52	52	52	52
53	53	53	53	53	53	53	53
54	54	54	54	54	54	54	54
55	55	55	55	55	55	55	55
56	56	56	56	56	56	56	56
57	57	57	57	57	57	57	57
58	58	58	58	58	58	58	58
59	59	59	59	59	59	59	59
60	60	60	60	60	60	60	60
61	61	61	61	61	61	61	61
62	62	62	62	62	62	62	62
63	63	63	63	63	63	63	63
64	64	64	64	64	64	64	64
65	65	65	65	65	65	65	65
66	66	66	66	66	66	66	66
67	67	67	67	67	67	67	67
68	68	68	68	68	68	68	68
69	69	69	69	69	69	69	69
70	70	70	70	70	70	70	70
71	71	71	71	71	71	71	71
72	72	72	72	72	72	72	72
73	73	73	73	73	73	73	73
74	74	74	74	74	74	74	74
75	75	75	75	75	75	75	75
76	76	76	76	76	76	76	76
77	77	77	77	77	77	77	77
78	78	78	78	78	78	78	78
79	79	79	79	79	79	79	79
80	80	80	80	80	80	80	80
81	81	81	81	81	81	81	81
82	82	82	82	82	82	82	82
83	83	83	83	83	83	83	83
84	84	84	84	84	84	84	84
85	85	85	85	85	85	85	85
86	86	86	86	86	86	86	86
87	87	87	87	87	87	87	87
88	88	88	88	88	88	88	88
89	89	89	89	89	89	89	89
90	90	90	90	90	90	90	90
91	91	91	91	91	91	91	91
92	92	92	92	92	92	92	92
93	93	93	93	93	93	93	93
94	94	94	94	94	94	94	94
95	95	95	95	95	95	95	95
96	96	96	96	96	96	96	96
97	97	97	97	97	97	97	97
98	98	98	98	98	98	98	98
99	99	99	99	99	99	99	99
100	100	100	100	100	100	100	100

WZK 22/22/22-22  
WZK 22/22/22-22



Regulamento nº 1.000  
 Regulamento nº 1.000  
 Regulamento nº 1.000  
 Regulamento nº 1.000

Item	Descrição	Quantidade	Valor Unitário	Valor Total
1	...	...	...	...
2	...	...	...	...
3	...	...	...	...
4	...	...	...	...
5	...	...	...	...
6	...	...	...	...
7	...	...	...	...
8	...	...	...	...
9	...	...	...	...
10	...	...	...	...
11	...	...	...	...
12	...	...	...	...
13	...	...	...	...
14	...	...	...	...
15	...	...	...	...
16	...	...	...	...
17	...	...	...	...
18	...	...	...	...
19	...	...	...	...
20	...	...	...	...
21	...	...	...	...
22	...	...	...	...
23	...	...	...	...
24	...	...	...	...
25	...	...	...	...
26	...	...	...	...
27	...	...	...	...
28	...	...	...	...
29	...	...	...	...
30	...	...	...	...
31	...	...	...	...
32	...	...	...	...
33	...	...	...	...
34	...	...	...	...
35	...	...	...	...
36	...	...	...	...
37	...	...	...	...
38	...	...	...	...
39	...	...	...	...
40	...	...	...	...
41	...	...	...	...
42	...	...	...	...
43	...	...	...	...
44	...	...	...	...
45	...	...	...	...
46	...	...	...	...
47	...	...	...	...
48	...	...	...	...
49	...	...	...	...
50	...	...	...	...
51	...	...	...	...
52	...	...	...	...
53	...	...	...	...
54	...	...	...	...
55	...	...	...	...
56	...	...	...	...
57	...	...	...	...
58	...	...	...	...
59	...	...	...	...
60	...	...	...	...
61	...	...	...	...
62	...	...	...	...
63	...	...	...	...
64	...	...	...	...
65	...	...	...	...
66	...	...	...	...
67	...	...	...	...
68	...	...	...	...
69	...	...	...	...
70	...	...	...	...
71	...	...	...	...
72	...	...	...	...
73	...	...	...	...
74	...	...	...	...
75	...	...	...	...
76	...	...	...	...
77	...	...	...	...
78	...	...	...	...
79	...	...	...	...
80	...	...	...	...
81	...	...	...	...
82	...	...	...	...
83	...	...	...	...
84	...	...	...	...
85	...	...	...	...
86	...	...	...	...
87	...	...	...	...
88	...	...	...	...
89	...	...	...	...
90	...	...	...	...
91	...	...	...	...
92	...	...	...	...
93	...	...	...	...
94	...	...	...	...
95	...	...	...	...
96	...	...	...	...
97	...	...	...	...
98	...	...	...	...
99	...	...	...	...
100	...	...	...	...

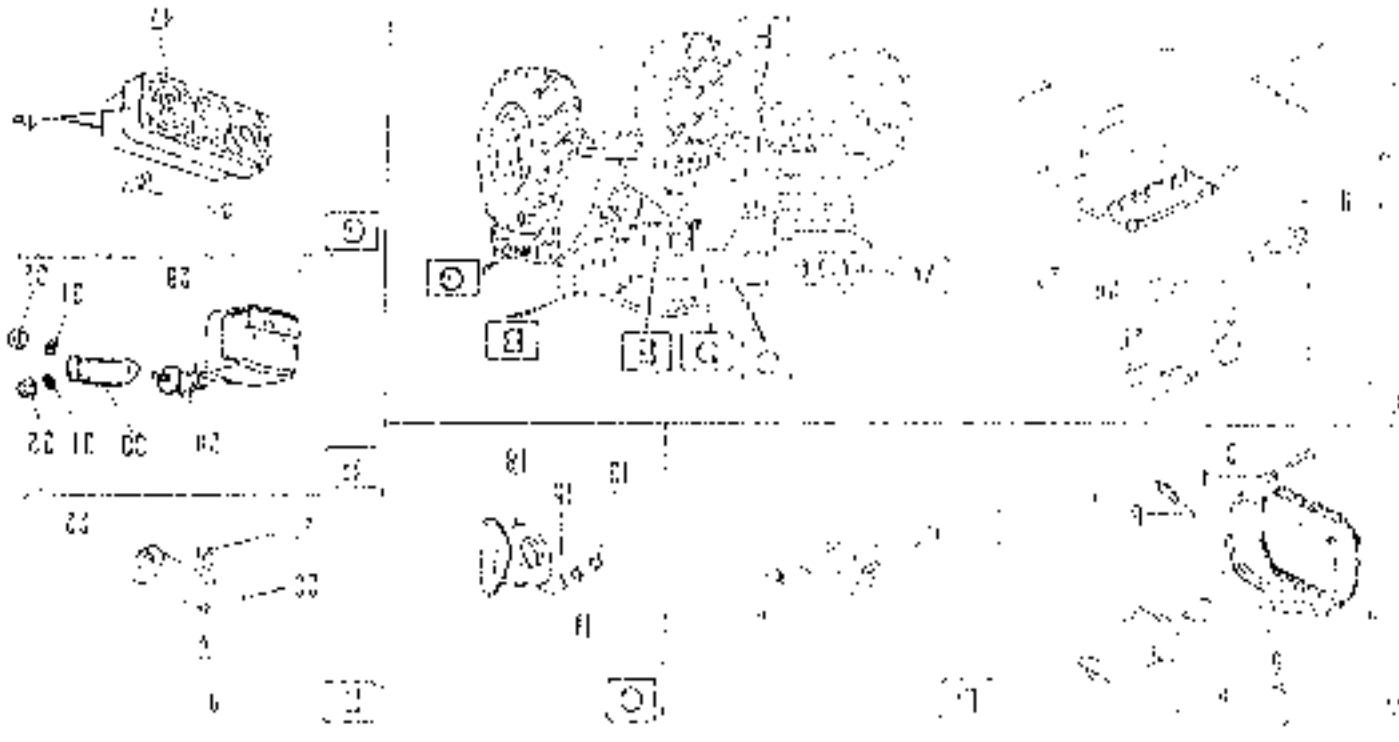

MOD. 8/20/22-3W  
 TAV 27 REV

4 5 8 = 8 5 4  
 2 1 0 9 = 9 0 1 2

Indicaciones de validad  
 Gültigkeitsangaben  
 Signtificazioni a validità  
 Usage code  
 Señalizaciones de validad

No. pieza	No. de comanda	Part No.	Part No.	No. de comanda	No. de comanda	No. de comanda	No. de comanda	No. de comanda	No. de comanda
1	91 8628 000	91 8628 000	91 8628 000	91 8628 000	91 8628 000	91 8628 000	91 8628 000	91 8628 000	91 8628 000
2	91 8628 000	91 8628 000	91 8628 000	91 8628 000	91 8628 000	91 8628 000	91 8628 000	91 8628 000	91 8628 000
3	91 8628 000	91 8628 000	91 8628 000	91 8628 000	91 8628 000	91 8628 000	91 8628 000	91 8628 000	91 8628 000
4	91 8628 000	91 8628 000	91 8628 000	91 8628 000	91 8628 000	91 8628 000	91 8628 000	91 8628 000	91 8628 000
5	91 8628 000	91 8628 000	91 8628 000	91 8628 000	91 8628 000	91 8628 000	91 8628 000	91 8628 000	91 8628 000
6	91 8628 000	91 8628 000	91 8628 000	91 8628 000	91 8628 000	91 8628 000	91 8628 000	91 8628 000	91 8628 000
7	91 8628 000	91 8628 000	91 8628 000	91 8628 000	91 8628 000	91 8628 000	91 8628 000	91 8628 000	91 8628 000
8	91 8628 000	91 8628 000	91 8628 000	91 8628 000	91 8628 000	91 8628 000	91 8628 000	91 8628 000	91 8628 000
9	91 8628 000	91 8628 000	91 8628 000	91 8628 000	91 8628 000	91 8628 000	91 8628 000	91 8628 000	91 8628 000
10	91 8628 000	91 8628 000	91 8628 000	91 8628 000	91 8628 000	91 8628 000	91 8628 000	91 8628 000	91 8628 000
11	91 8628 000	91 8628 000	91 8628 000	91 8628 000	91 8628 000	91 8628 000	91 8628 000	91 8628 000	91 8628 000
12	91 8628 000	91 8628 000	91 8628 000	91 8628 000	91 8628 000	91 8628 000	91 8628 000	91 8628 000	91 8628 000
13	91 8628 000	91 8628 000	91 8628 000	91 8628 000	91 8628 000	91 8628 000	91 8628 000	91 8628 000	91 8628 000
14	91 8628 000	91 8628 000	91 8628 000	91 8628 000	91 8628 000	91 8628 000	91 8628 000	91 8628 000	91 8628 000
15	91 8628 000	91 8628 000	91 8628 000	91 8628 000	91 8628 000	91 8628 000	91 8628 000	91 8628 000	91 8628 000
16	91 8628 000	91 8628 000	91 8628 000	91 8628 000	91 8628 000	91 8628 000	91 8628 000	91 8628 000	91 8628 000
17	91 8628 000	91 8628 000	91 8628 000	91 8628 000	91 8628 000	91 8628 000	91 8628 000	91 8628 000	91 8628 000
18	91 8628 000	91 8628 000	91 8628 000	91 8628 000	91 8628 000	91 8628 000	91 8628 000	91 8628 000	91 8628 000
19	91 8628 000	91 8628 000	91 8628 000	91 8628 000	91 8628 000	91 8628 000	91 8628 000	91 8628 000	91 8628 000
20	91 8628 000	91 8628 000	91 8628 000	91 8628 000	91 8628 000	91 8628 000	91 8628 000	91 8628 000	91 8628 000
21	91 8628 000	91 8628 000	91 8628 000	91 8628 000	91 8628 000	91 8628 000	91 8628 000	91 8628 000	91 8628 000
22	91 8628 000	91 8628 000	91 8628 000	91 8628 000	91 8628 000	91 8628 000	91 8628 000	91 8628 000	91 8628 000
23	91 8628 000	91 8628 000	91 8628 000	91 8628 000	91 8628 000	91 8628 000	91 8628 000	91 8628 000	91 8628 000
24	91 8628 000	91 8628 000	91 8628 000	91 8628 000	91 8628 000	91 8628 000	91 8628 000	91 8628 000	91 8628 000
25	91 8628 000	91 8628 000	91 8628 000	91 8628 000	91 8628 000	91 8628 000	91 8628 000	91 8628 000	91 8628 000
26	91 8628 000	91 8628 000	91 8628 000	91 8628 000	91 8628 000	91 8628 000	91 8628 000	91 8628 000	91 8628 000
27	91 8628 000	91 8628 000	91 8628 000	91 8628 000	91 8628 000	91 8628 000	91 8628 000	91 8628 000	91 8628 000
28	91 8628 000	91 8628 000	91 8628 000	91 8628 000	91 8628 000	91 8628 000	91 8628 000	91 8628 000	91 8628 000
29	91 8628 000	91 8628 000	91 8628 000	91 8628 000	91 8628 000	91 8628 000	91 8628 000	91 8628 000	91 8628 000
30	91 8628 000	91 8628 000	91 8628 000	91 8628 000	91 8628 000	91 8628 000	91 8628 000	91 8628 000	91 8628 000

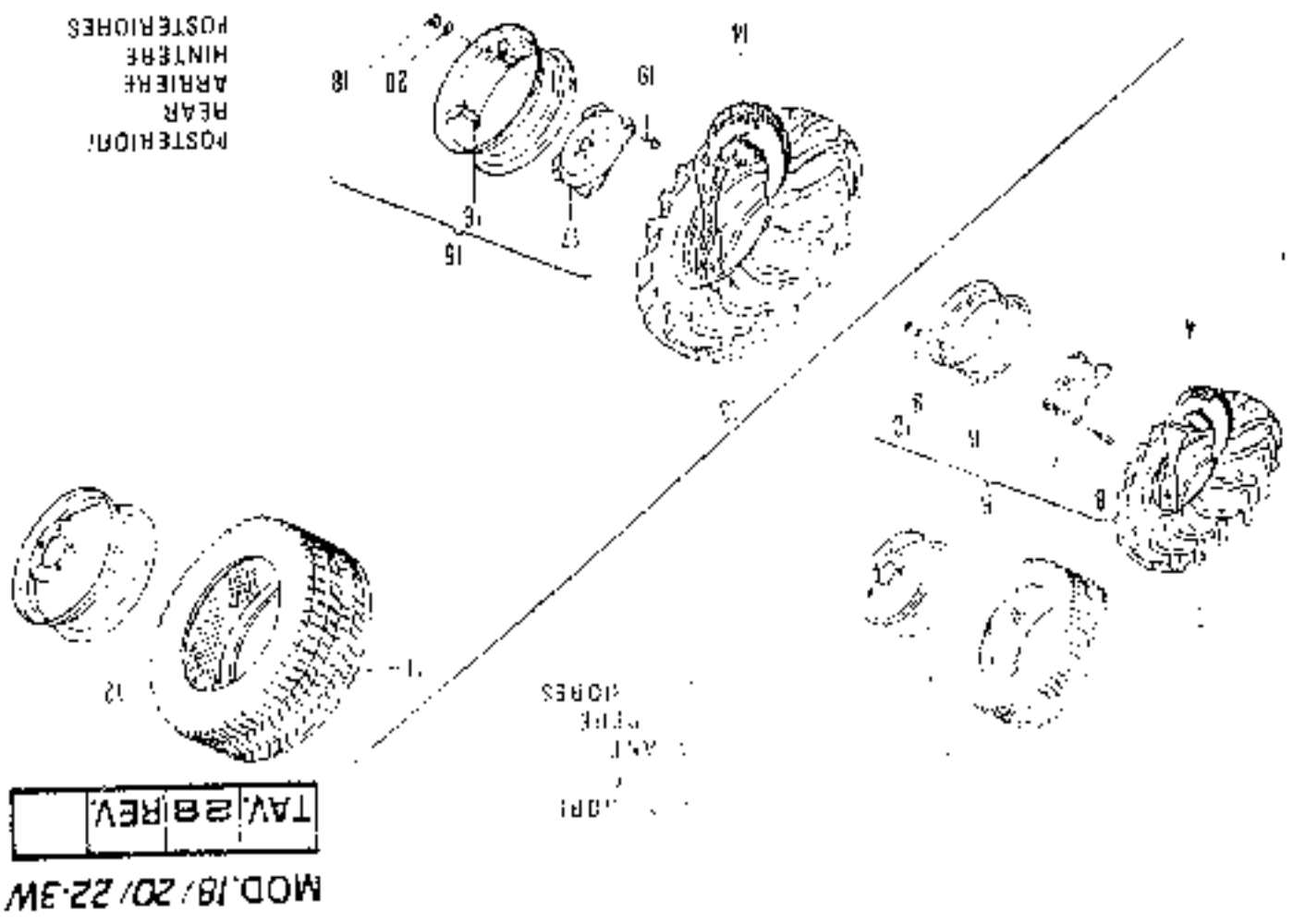





Con la cavallata all'indietro  
 con la cavallata all'indietro  
 con la cavallata all'indietro

Legenda di simboli  
 Legenda di simboli  
 Legenda di simboli

① - 20.30  
 ② - 20.30  
 ③ - 20.30

No. parte	Descrizione	Q.tà	Unità	No. parte	Descrizione	Q.tà	Unità
1	...	1	...	1	...	1	...
2	...	1	...	2	...	1	...
3	...	1	...	3	...	1	...
4	...	1	...	4	...	1	...
5	...	1	...	5	...	1	...
6	...	1	...	6	...	1	...
7	...	1	...	7	...	1	...
8	...	1	...	8	...	1	...
9	...	1	...	9	...	1	...
10	...	1	...	10	...	1	...
11	...	1	...	11	...	1	...
12	...	1	...	12	...	1	...
13	...	1	...	13	...	1	...
14	...	1	...	14	...	1	...
15	...	1	...	15	...	1	...
16	...	1	...	16	...	1	...
17	...	1	...	17	...	1	...
18	...	1	...	18	...	1	...
19	...	1	...	19	...	1	...
20	...	1	...	20	...	1	...
21	...	1	...	21	...	1	...
22	...	1	...	22	...	1	...
23	...	1	...	23	...	1	...
24	...	1	...	24	...	1	...
25	...	1	...	25	...	1	...
26	...	1	...	26	...	1	...
27	...	1	...	27	...	1	...
28	...	1	...	28	...	1	...
29	...	1	...	29	...	1	...
30	...	1	...	30	...	1	...
31	...	1	...	31	...	1	...
32	...	1	...	32	...	1	...
33	...	1	...	33	...	1	...
34	...	1	...	34	...	1	...
35	...	1	...	35	...	1	...
36	...	1	...	36	...	1	...
37	...	1	...	37	...	1	...
38	...	1	...	38	...	1	...
39	...	1	...	39	...	1	...
40	...	1	...	40	...	1	...
41	...	1	...	41	...	1	...
42	...	1	...	42	...	1	...
43	...	1	...	43	...	1	...
44	...	1	...	44	...	1	...
45	...	1	...	45	...	1	...
46	...	1	...	46	...	1	...
47	...	1	...	47	...	1	...
48	...	1	...	48	...	1	...
49	...	1	...	49	...	1	...
50	...	1	...	50	...	1	...

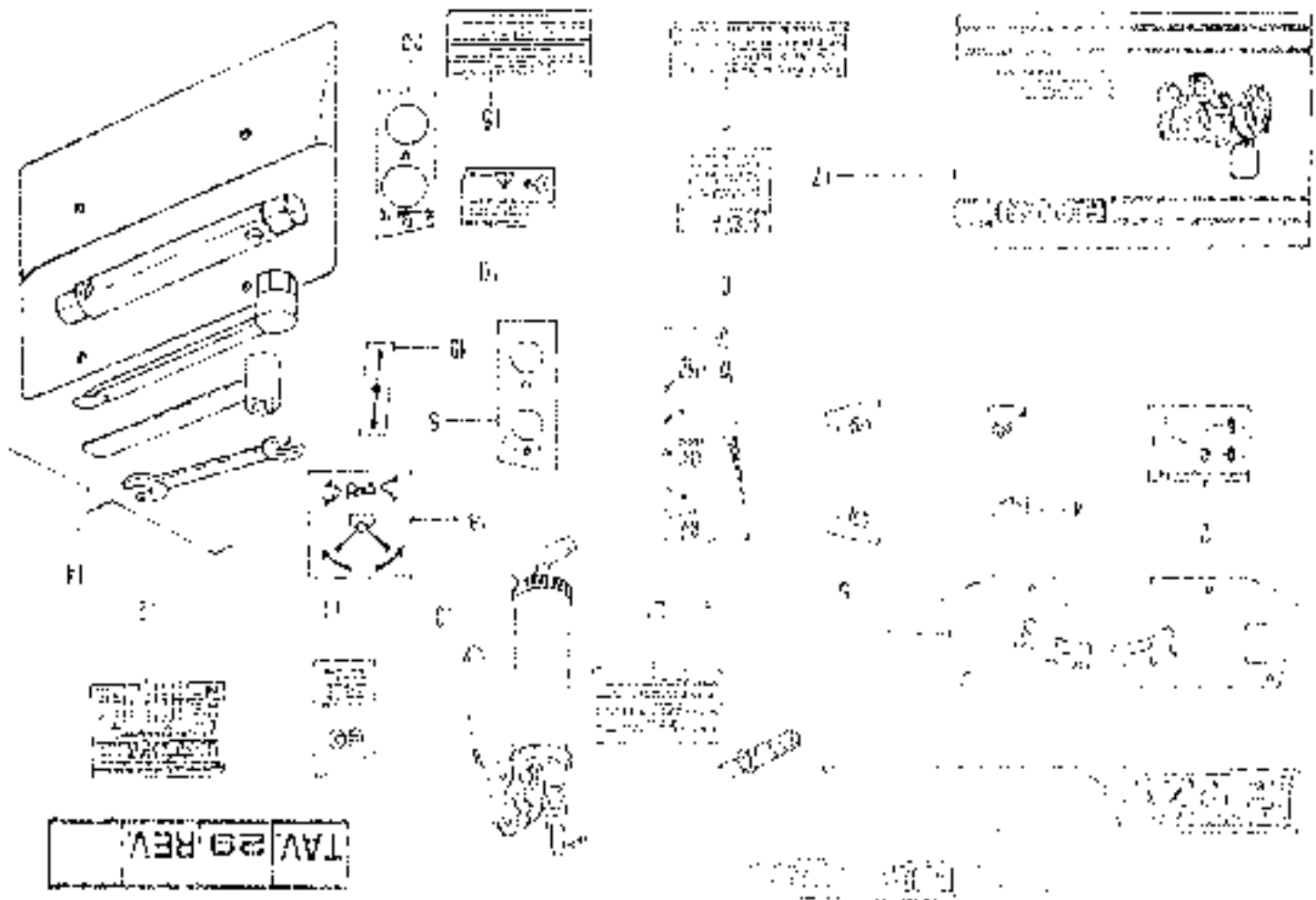

MOD. 18/20/22-3W  
 TAV. 29 REV.



A RICH BAY  
 THE PROCEEDS  
 FOR BENEFIT

Compensation of Virginia  
 1988 Code  
 Virginia Statutes  
 Code of Virginia  
 1988 Code  
 Virginia Statutes  
 Code of Virginia

No. of Shares	No. of Shares	No. of Shares	No. of Shares	No. of Shares	No. of Shares
15,000.00	15,000.00	15,000.00	15,000.00	15,000.00	15,000.00
15,000.00	15,000.00	15,000.00	15,000.00	15,000.00	15,000.00
15,000.00	15,000.00	15,000.00	15,000.00	15,000.00	15,000.00
15,000.00	15,000.00	15,000.00	15,000.00	15,000.00	15,000.00
15,000.00	15,000.00	15,000.00	15,000.00	15,000.00	15,000.00
15,000.00	15,000.00	15,000.00	15,000.00	15,000.00	15,000.00
15,000.00	15,000.00	15,000.00	15,000.00	15,000.00	15,000.00
15,000.00	15,000.00	15,000.00	15,000.00	15,000.00	15,000.00
15,000.00	15,000.00	15,000.00	15,000.00	15,000.00	15,000.00
15,000.00	15,000.00	15,000.00	15,000.00	15,000.00	15,000.00
15,000.00	15,000.00	15,000.00	15,000.00	15,000.00	15,000.00
15,000.00	15,000.00	15,000.00	15,000.00	15,000.00	15,000.00
15,000.00	15,000.00	15,000.00	15,000.00	15,000.00	15,000.00
15,000.00	15,000.00	15,000.00	15,000.00	15,000.00	15,000.00
15,000.00	15,000.00	15,000.00	15,000.00	15,000.00	15,000.00
15,000.00	15,000.00	15,000.00	15,000.00	15,000.00	15,000.00
15,000.00	15,000.00	15,000.00	15,000.00	15,000.00	15,000.00

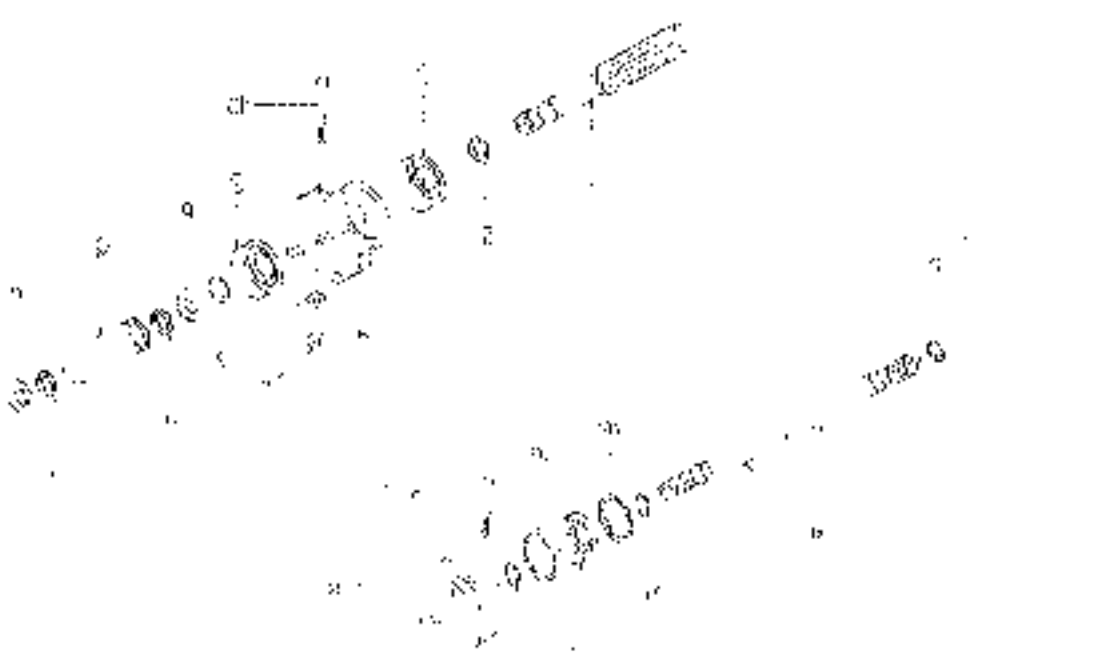

MOD. 18 / 20 / 22-3W  
 TAV 30 REV

Page No.	Page Content	Page No.	Page Content
34		34	
35	2000 1700 1200 1100	35	
36	copy copy copy copy	36	
37	DISTRICT DISTRICT DISTRICT	37	
38	DISTRICT	38	
39		39	
40		40	
41		41	
42		42	
43		43	
44		44	
45		45	
46		46	
47		47	
48		48	
49		49	
50		50	
51		51	
52		52	
53		53	
54		54	
55		55	
56		56	
57		57	
58		58	
59		59	
60		60	
61		61	
62		62	
63		63	
64		64	
65		65	
66		66	
67		67	
68		68	
69		69	
70		70	
71		71	
72		72	
73		73	
74		74	
75		75	
76		76	
77		77	
78		78	
79		79	
80		80	
81		81	
82		82	
83		83	
84		84	
85		85	
86		86	
87		87	
88		88	
89		89	
90		90	
91		91	
92		92	
93		93	
94		94	
95		95	
96		96	
97		97	
98		98	
99		99	
100		100	

RECORDED

APPROVED FOR  
31/08/2008  
11:22 AM

E1			
E2	<p>SHAZOJ PEN SHAZOJ AT THE POST OFFICE          L'ATTO PEN SHAZOJ AT THE POST OFFICE          SHAZOJ PEN SHAZOJ AT THE POST OFFICE          SHAZOJ PEN SHAZOJ AT THE POST OFFICE</p>	46	
E3	<p>SHAZOJ PEN SHAZOJ AT THE POST OFFICE          SHAZOJ PEN SHAZOJ AT THE POST OFFICE          SHAZOJ PEN SHAZOJ AT THE POST OFFICE</p>	47	
E4	<p>SHAZOJ PEN SHAZOJ AT THE POST OFFICE          SHAZOJ PEN SHAZOJ AT THE POST OFFICE          SHAZOJ PEN SHAZOJ AT THE POST OFFICE          SHAZOJ PEN SHAZOJ AT THE POST OFFICE</p>	48	
E5	<p>SHAZOJ PEN SHAZOJ AT THE POST OFFICE          SHAZOJ PEN SHAZOJ AT THE POST OFFICE          SHAZOJ PEN SHAZOJ AT THE POST OFFICE</p>	49	
E6	<p>SHAZOJ PEN SHAZOJ AT THE POST OFFICE          SHAZOJ PEN SHAZOJ AT THE POST OFFICE          SHAZOJ PEN SHAZOJ AT THE POST OFFICE</p>	50	
E7	<p>SHAZOJ PEN SHAZOJ AT THE POST OFFICE          SHAZOJ PEN SHAZOJ AT THE POST OFFICE          SHAZOJ PEN SHAZOJ AT THE POST OFFICE</p>	51	
E8	<p>SHAZOJ PEN SHAZOJ AT THE POST OFFICE          SHAZOJ PEN SHAZOJ AT THE POST OFFICE          SHAZOJ PEN SHAZOJ AT THE POST OFFICE</p>	52	
E9	<p>SHAZOJ PEN SHAZOJ AT THE POST OFFICE          SHAZOJ PEN SHAZOJ AT THE POST OFFICE          SHAZOJ PEN SHAZOJ AT THE POST OFFICE</p>	53	

18/20/22-3W

NO. 18/20/22-3W

NO. 18/20/22-3W



Depósitos em dólares  
 Códigos de pedido  
 Códigos de pedido  
 Códigos de pedido  
 Códigos de pedido

Item	Descrição	Quantidade	Valor Unitário	Valor Total	Observações
1	SE 42 A	1	1000000	1000000	
2	WASH SYSTEM	1	1000000	1000000	
3	M 25 F	1	1000000	1000000	
4	WASH SYSTEM	1	1000000	1000000	
5	WASH SYSTEM	1	1000000	1000000	
6	WASH SYSTEM	1	1000000	1000000	
7	WASH SYSTEM	1	1000000	1000000	
8	WASH SYSTEM	1	1000000	1000000	
9	WASH SYSTEM	1	1000000	1000000	
10	WASH SYSTEM	1	1000000	1000000	

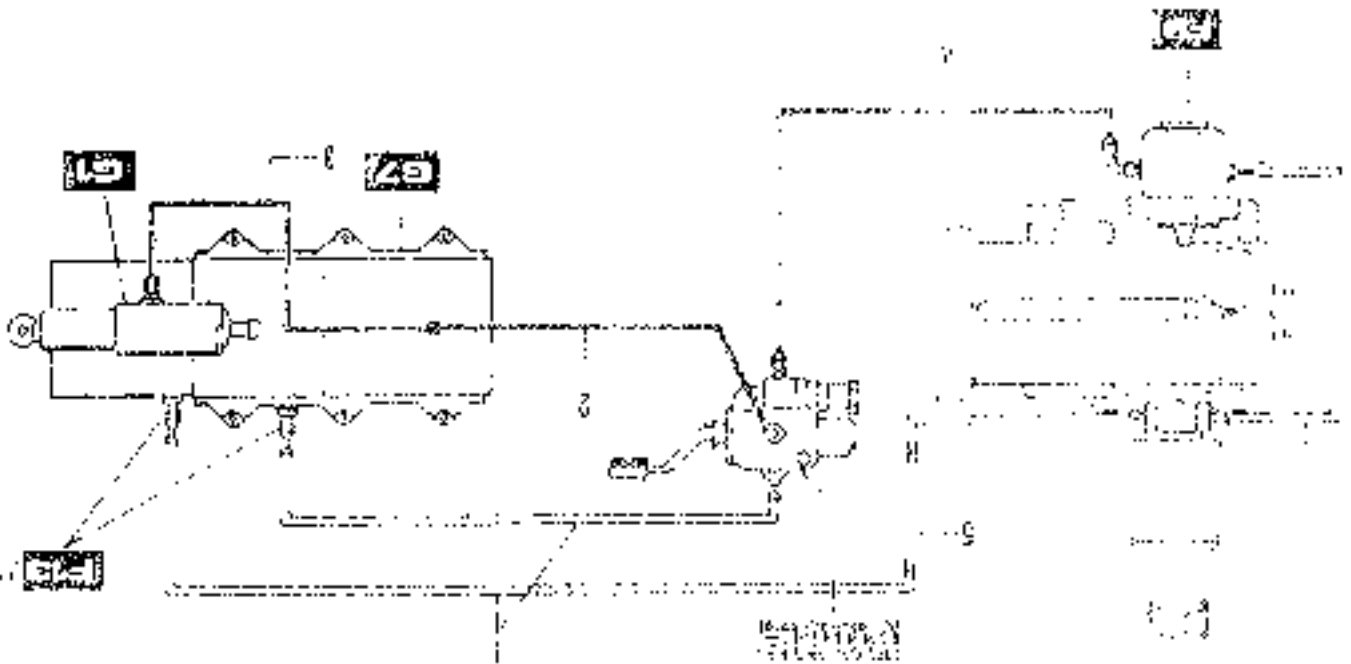

TAV 01 REV

00.18/20/22.34



Engenharia de Instalações  
 Engenharia de Eléctricidade  
 Engenharia de Automação  
 Engenharia de Energia

Descrição	Quantidade	Valor Unitário (€)	Valor Total (€)
1.000	1.000	15,00	15.000,00
2.000	2.000	15,00	30.000,00
3.000	3.000	15,00	45.000,00
4.000	4.000	15,00	60.000,00
5.000	5.000	15,00	75.000,00
6.000	6.000	15,00	90.000,00
7.000	7.000	15,00	105.000,00
8.000	8.000	15,00	120.000,00
9.000	9.000	15,00	135.000,00
10.000	10.000	15,00	150.000,00

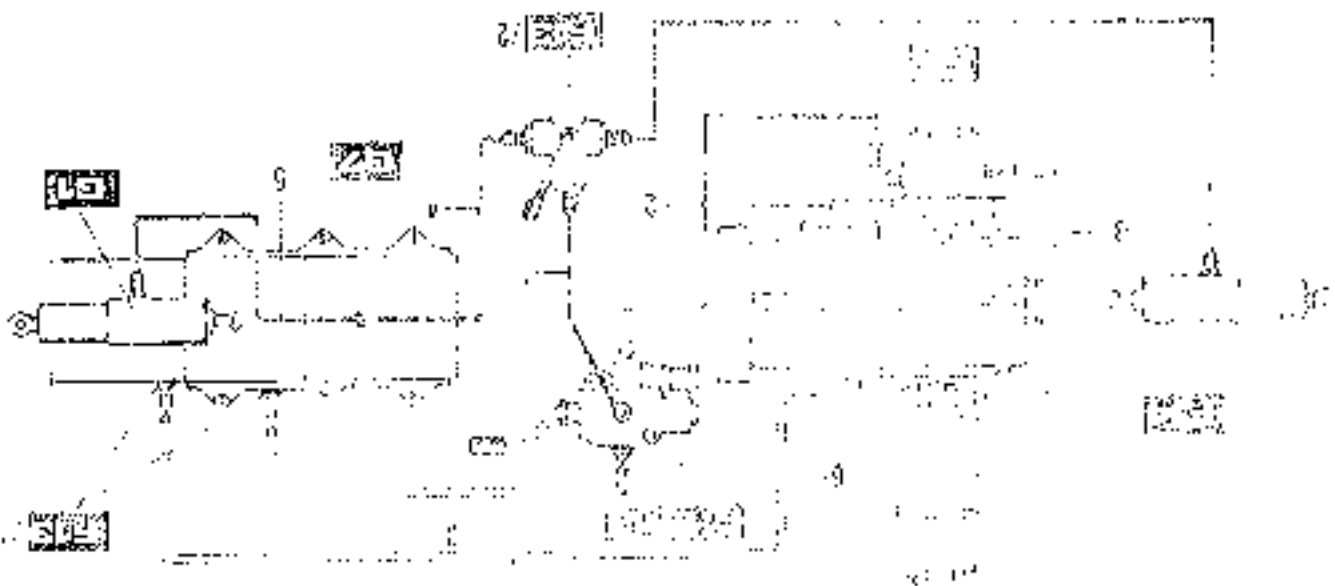

MOD: 0/22-3M  
 1M 32 REV



Exposition de vente  
 Liste des  
 Equipements  
 Equipements de police

No. de pièce	Quantité	Description	Unité	Quantité	Description	Unité	Quantité	Description	Unité	
81	1	Boite à outils	Boite	82	5060	Boite à outils	Boite	83	5060	Boite à outils
84	1	Boite à outils	Boite	85	5060	Boite à outils	Boite	86	5060	Boite à outils
87	1	Boite à outils	Boite	88	5060	Boite à outils	Boite	89	5060	Boite à outils
90	1	Boite à outils	Boite	91	5060	Boite à outils	Boite	92	5060	Boite à outils
93	1	Boite à outils	Boite	94	5060	Boite à outils	Boite	95	5060	Boite à outils
96	1	Boite à outils	Boite	97	5060	Boite à outils	Boite	98	5060	Boite à outils
99	1	Boite à outils	Boite	100	5060	Boite à outils	Boite	101	5060	Boite à outils
102	1	Boite à outils	Boite	103	5060	Boite à outils	Boite	104	5060	Boite à outils
105	1	Boite à outils	Boite	106	5060	Boite à outils	Boite	107	5060	Boite à outils
108	1	Boite à outils	Boite	109	5060	Boite à outils	Boite	110	5060	Boite à outils
111	1	Boite à outils	Boite	112	5060	Boite à outils	Boite	113	5060	Boite à outils
114	1	Boite à outils	Boite	115	5060	Boite à outils	Boite	116	5060	Boite à outils
117	1	Boite à outils	Boite	118	5060	Boite à outils	Boite	119	5060	Boite à outils
120	1	Boite à outils	Boite	121	5060	Boite à outils	Boite	122	5060	Boite à outils
123	1	Boite à outils	Boite	124	5060	Boite à outils	Boite	125	5060	Boite à outils
126	1	Boite à outils	Boite	127	5060	Boite à outils	Boite	128	5060	Boite à outils
129	1	Boite à outils	Boite	130	5060	Boite à outils	Boite	131	5060	Boite à outils
132	1	Boite à outils	Boite	133	5060	Boite à outils	Boite	134	5060	Boite à outils
135	1	Boite à outils	Boite	136	5060	Boite à outils	Boite	137	5060	Boite à outils
138	1	Boite à outils	Boite	139	5060	Boite à outils	Boite	140	5060	Boite à outils
141	1	Boite à outils	Boite	142	5060	Boite à outils	Boite	143	5060	Boite à outils
144	1	Boite à outils	Boite	145	5060	Boite à outils	Boite	146	5060	Boite à outils
147	1	Boite à outils	Boite	148	5060	Boite à outils	Boite	149	5060	Boite à outils
150	1	Boite à outils	Boite	151	5060	Boite à outils	Boite	152	5060	Boite à outils
153	1	Boite à outils	Boite	154	5060	Boite à outils	Boite	155	5060	Boite à outils
156	1	Boite à outils	Boite	157	5060	Boite à outils	Boite	158	5060	Boite à outils
159	1	Boite à outils	Boite	160	5060	Boite à outils	Boite	161	5060	Boite à outils
162	1	Boite à outils	Boite	163	5060	Boite à outils	Boite	164	5060	Boite à outils
165	1	Boite à outils	Boite	166	5060	Boite à outils	Boite	167	5060	Boite à outils
168	1	Boite à outils	Boite	169	5060	Boite à outils	Boite	170	5060	Boite à outils
171	1	Boite à outils	Boite	172	5060	Boite à outils	Boite	173	5060	Boite à outils
174	1	Boite à outils	Boite	175	5060	Boite à outils	Boite	176	5060	Boite à outils
177	1	Boite à outils	Boite	178	5060	Boite à outils	Boite	179	5060	Boite à outils
180	1	Boite à outils	Boite	181	5060	Boite à outils	Boite	182	5060	Boite à outils
183	1	Boite à outils	Boite	184	5060	Boite à outils	Boite	185	5060	Boite à outils
186	1	Boite à outils	Boite	187	5060	Boite à outils	Boite	188	5060	Boite à outils
189	1	Boite à outils	Boite	190	5060	Boite à outils	Boite	191	5060	Boite à outils
192	1	Boite à outils	Boite	193	5060	Boite à outils	Boite	194	5060	Boite à outils
195	1	Boite à outils	Boite	196	5060	Boite à outils	Boite	197	5060	Boite à outils
198	1	Boite à outils	Boite	199	5060	Boite à outils	Boite	200	5060	Boite à outils

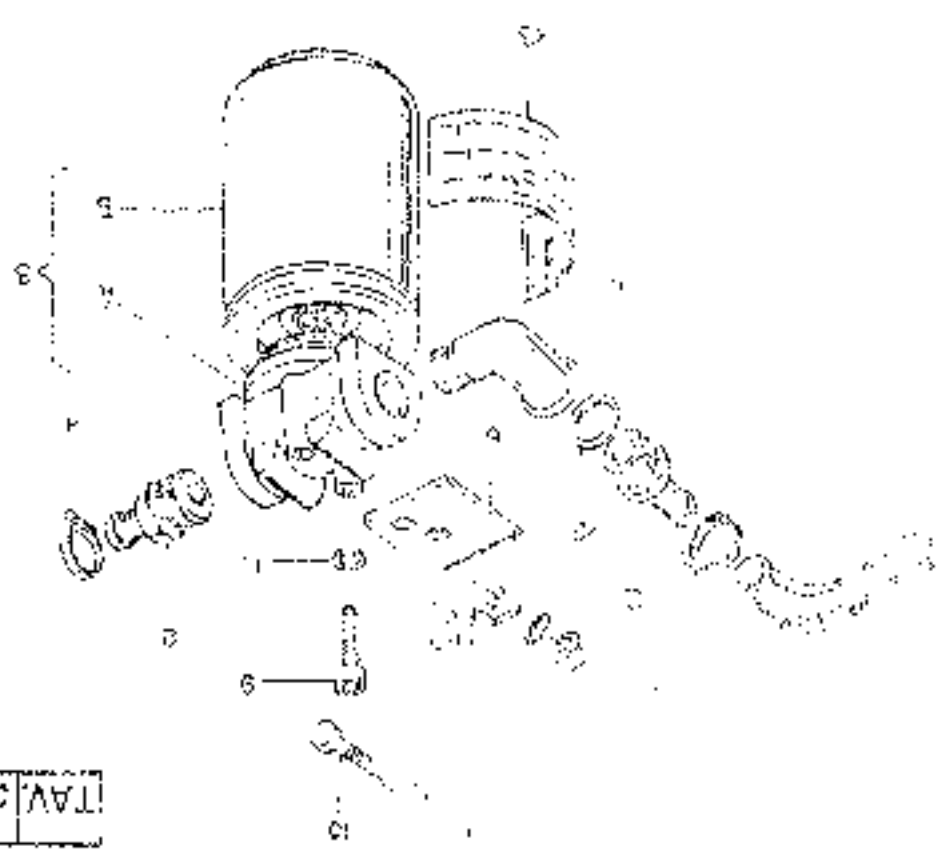

MOJ.18/20/22-3W  
 TAV.35 REV







Con sollevatore post. normale  
 With rear standard lifter  
 Avec relevage normal arriere

Indicazioni di vendita  
 Significations de ventes  
 Indications de vendas

No. pezzo No. piece No. part	Ind. di riferimento Ref. no. Ref. no.	Descrizione Description Description	Qtz. richiesto Req. qty. Req. qty.	Qtz. in stock Qtz. in stock Qtz. in stock	Qtz. in commande Qtz. in commande Qtz. in commande	Qtz. da perdere Qtz. to be lost Qtz. to be lost	Qtz. di magazzino Qtz. in stock Qtz. in stock	Qtz. da ricevere Qtz. to receive Qtz. to receive	Qtz. da consegnare Qtz. to deliver Qtz. to deliver	Qtz. da ordinare Qtz. to order Qtz. to order
1	84.6800.040									
2	15.0026.039									
3	63.7534.000									
4	61.4609.020									
5	62.7143.000									
6	63.5510.030									
7	61.7462.000									
8	64.2517.000									
9	64.3340.010									
10	64.1551.000									
11	64.2510.040									
12	66.2909.000									
13	65.3685.000									
14	64.4586.000									
15	84.6800.000									

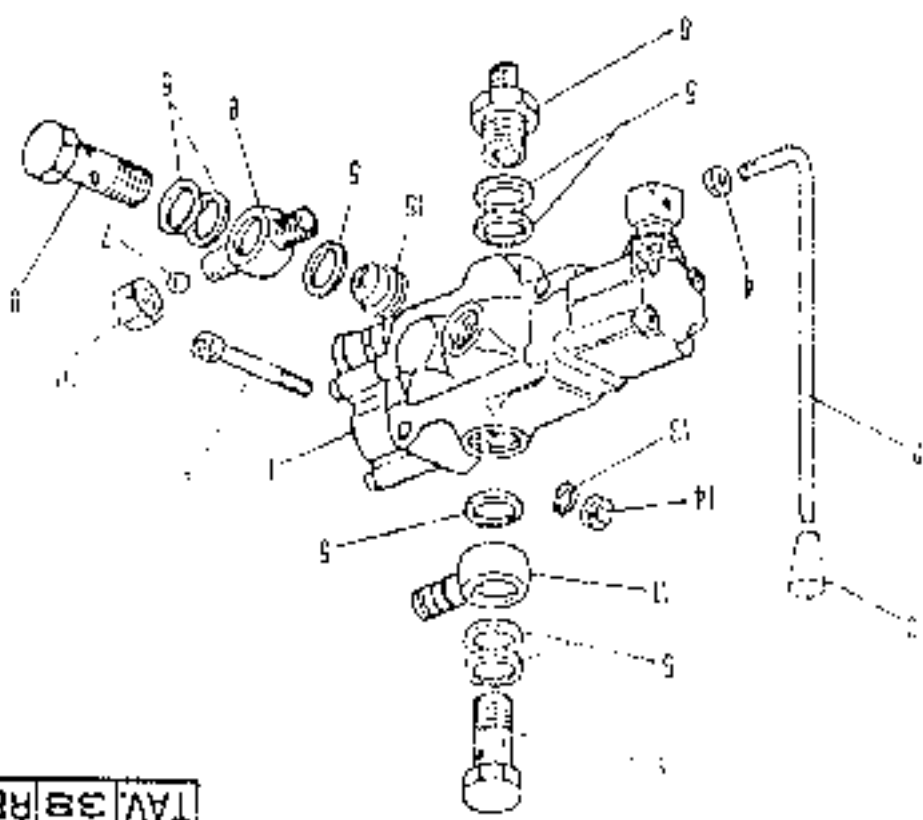

TAV. 37 REV. 39

MOD. 18/20/22-3W



Segna Anunci e Vite 2  
 Segna Anunci e Vite 1  
 Segna Anunci e Vite 0  
 Segna Anunci e Vite 3

Qtd. de peças	Part. no	Nome da peça	Qtd. de peças	Part. no	Nome da peça
1	01 001 001	1. de peça	1	01 001 001	1. de peça
2	01 001 002	1. de peça	2	01 001 002	1. de peça
3	01 001 003	1. de peça	3	01 001 003	1. de peça
4	01 001 004	1. de peça	4	01 001 004	1. de peça
5	01 001 005	1. de peça	5	01 001 005	1. de peça
6	01 001 006	1. de peça	6	01 001 006	1. de peça
7	01 001 007	1. de peça	7	01 001 007	1. de peça
8	01 001 008	1. de peça	8	01 001 008	1. de peça
9	01 001 009	1. de peça	9	01 001 009	1. de peça
10	01 001 010	1. de peça	10	01 001 010	1. de peça
11	01 001 011	1. de peça	11	01 001 011	1. de peça
12	01 001 012	1. de peça	12	01 001 012	1. de peça
13	01 001 013	1. de peça	13	01 001 013	1. de peça
14	01 001 014	1. de peça	14	01 001 014	1. de peça
15	01 001 015	1. de peça	15	01 001 015	1. de peça
16	01 001 016	1. de peça	16	01 001 016	1. de peça
17	01 001 017	1. de peça	17	01 001 017	1. de peça
18	01 001 018	1. de peça	18	01 001 018	1. de peça
19	01 001 019	1. de peça	19	01 001 019	1. de peça
20	01 001 020	1. de peça	20	01 001 020	1. de peça
21	01 001 021	1. de peça	21	01 001 021	1. de peça
22	01 001 022	1. de peça	22	01 001 022	1. de peça
23	01 001 023	1. de peça	23	01 001 023	1. de peça
24	01 001 024	1. de peça	24	01 001 024	1. de peça
25	01 001 025	1. de peça	25	01 001 025	1. de peça

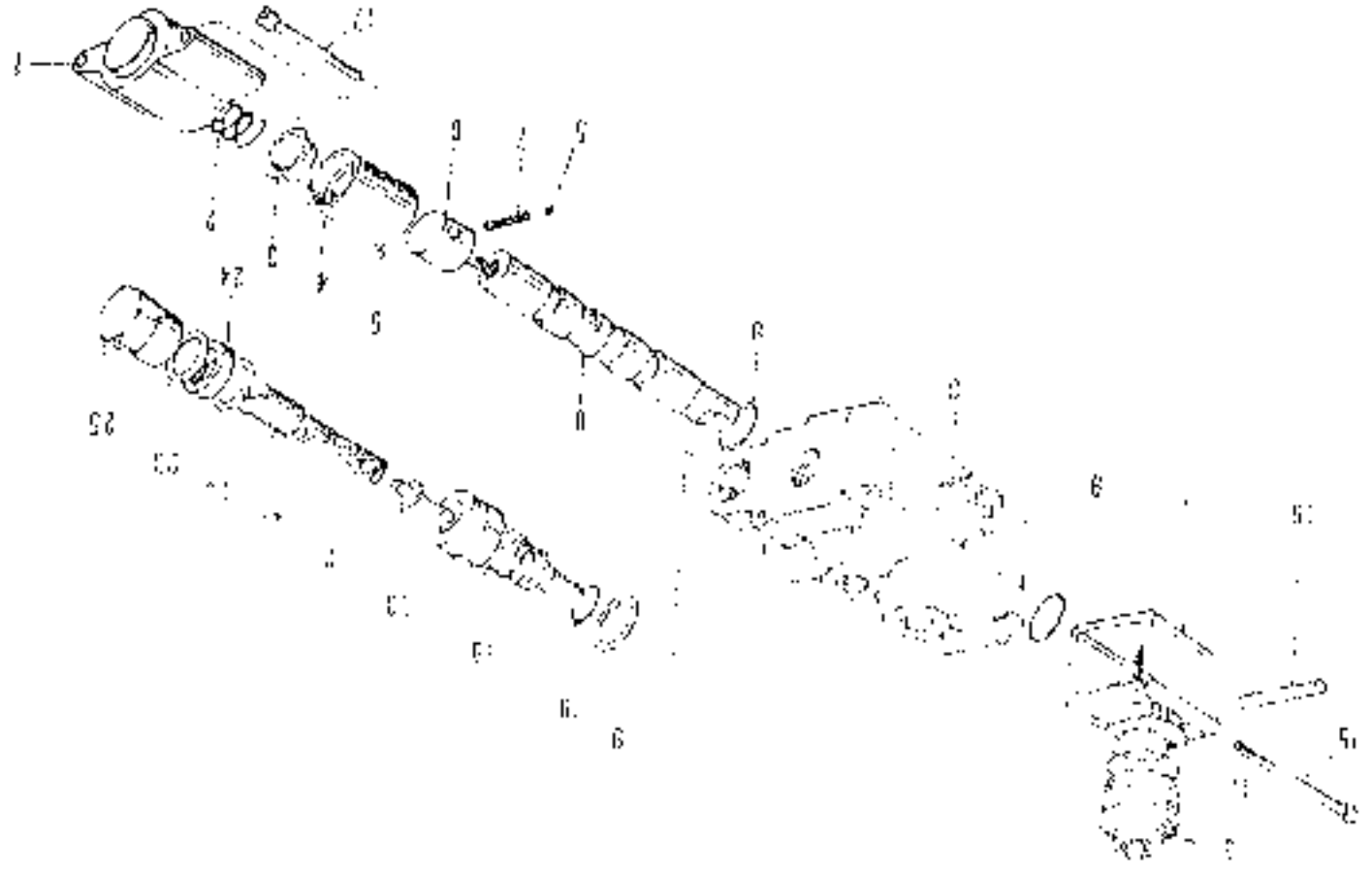

MOD. 18 / 20 / 22-3W  
 TAV. 39 REV.



F13

Con los que se indican a los efectos de  
 fabricar y ser estándar  
 Ando revisiones de los estándares  
 The revised and approved standards  
 Con los que se indican a los efectos de

Regulation of value  
 Signification de value  
 Classification de value  
 Indicators de value

Item	Quantity	Unit	Value	Material	Notes
1	1	kg	11 500.00	Aluminum	Part 1
2	2	kg	23 500.00	Aluminum	Part 2
3	2	kg	22 410.00	Aluminum	Part 3
4	4	kg	60 267.00	Aluminum	Part 4
5	5	kg	61 000.00	Aluminum	Part 5
6	6	kg	61 000.00	Aluminum	Part 6
7	7	kg	61 450.00	Aluminum	Part 7

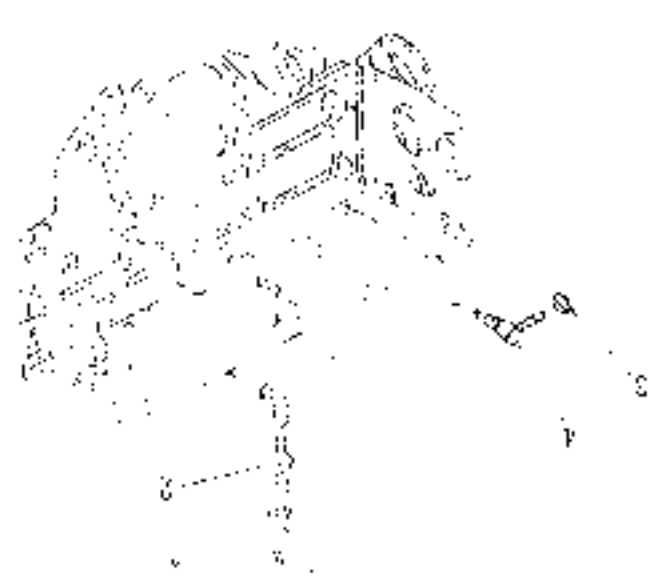
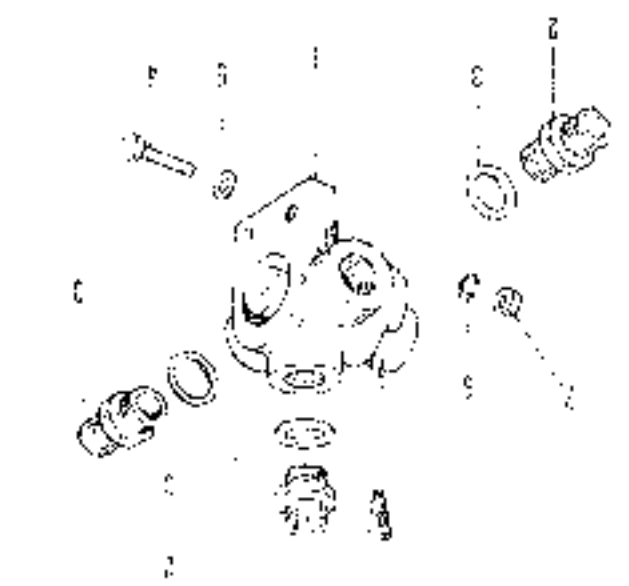

MOD. 18. 20/22-50  
 TAV 40 REV  
 TAV 40 REV

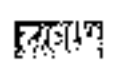

Regulation 2.001  
Plan Code  
Distribution de l'air  
Système de ventilation  
et de chauffage de l'air  
Conditionnement



Zone	Volume (m³)	Température (°C)	Humidité (%)	Qualité de l'air	Notes
Z1	1000	20	50	100	
Z2	1500	22	55	100	
Z3	2000	24	60	100	
Z4	2500	26	65	100	
Z5	3000	28	70	100	
Z6	3500	30	75	100	
Z7	4000	32	80	100	
Z8	4500	34	85	100	
Z9	5000	36	90	100	
Z10	5500	38	95	100	
Z11	6000	40	100	100	
Z12	6500	42	100	100	
Z13	7000	44	100	100	
Z14	7500	46	100	100	
Z15	8000	48	100	100	
Z16	8500	50	100	100	
Z17	9000	52	100	100	
Z18	9500	54	100	100	
Z19	10000	56	100	100	
Z20	10500	58	100	100	
Z21	11000	60	100	100	
Z22	11500	62	100	100	
Z23	12000	64	100	100	
Z24	12500	66	100	100	
Z25	13000	68	100	100	
Z26	13500	70	100	100	
Z27	14000	72	100	100	
Z28	14500	74	100	100	
Z29	15000	76	100	100	
Z30	15500	78	100	100	
Z31	16000	80	100	100	
Z32	16500	82	100	100	
Z33	17000	84	100	100	
Z34	17500	86	100	100	
Z35	18000	88	100	100	
Z36	18500	90	100	100	
Z37	19000	92	100	100	
Z38	19500	94	100	100	
Z39	20000	96	100	100	
Z40	20500	98	100	100	
Z41	21000	100	100	100	

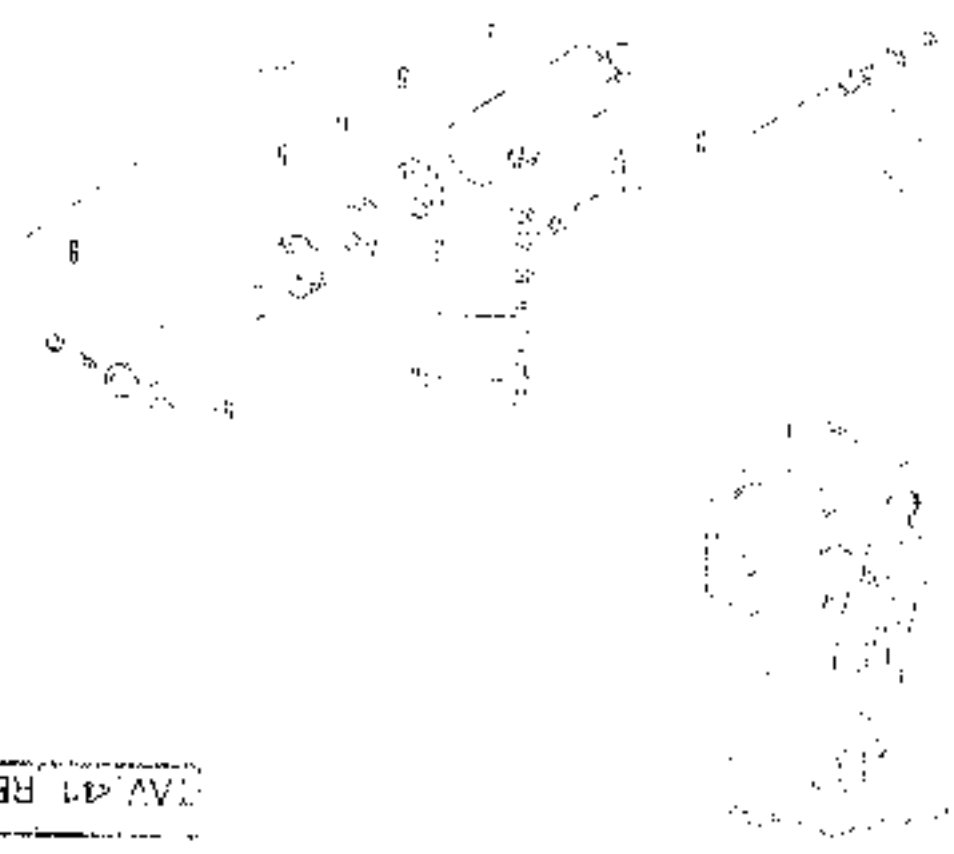

10/18/2022 10:22:31  
REV 01



- Signalisation de ville :  
 - Signalisation de village :  
 - Signalisation de village :  
 - Signalisation de village :  
 - Signalisation de village :

Code	Description	Quantité	Unité	Remarque
01	Signalisation de ville	1	Lot	
02	Signalisation de village	1	Lot	
03	Signalisation de village	1	Lot	
04	Signalisation de village	1	Lot	
05	Signalisation de village	1	Lot	
06	Signalisation de village	1	Lot	
07	Signalisation de village	1	Lot	
08	Signalisation de village	1	Lot	
09	Signalisation de village	1	Lot	
10	Signalisation de village	1	Lot	
11	Signalisation de village	1	Lot	
12	Signalisation de village	1	Lot	
13	Signalisation de village	1	Lot	
14	Signalisation de village	1	Lot	
15	Signalisation de village	1	Lot	
16	Signalisation de village	1	Lot	
17	Signalisation de village	1	Lot	
18	Signalisation de village	1	Lot	
19	Signalisation de village	1	Lot	
20	Signalisation de village	1	Lot	

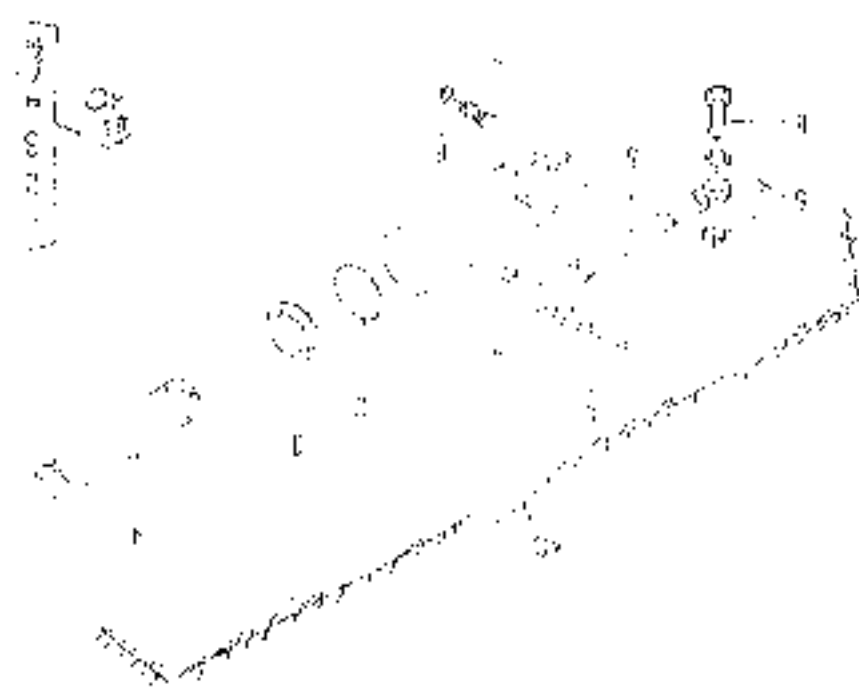

MOD. 18/20/22-3W  
 SAVANREV

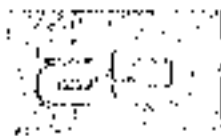

THE UNIVERSITY OF CHICAGO  
LIBRARY

UNIVERSITY OF CHICAGO  
LIBRARY

No. of students	No. of teachers	No. of classes	No. of sections	No. of students	No. of teachers	No. of classes	No. of sections
100	10	10	10	100	10	10	10
200	20	20	20	200	20	20	20
300	30	30	30	300	30	30	30
400	40	40	40	400	40	40	40
500	50	50	50	500	50	50	50
600	60	60	60	600	60	60	60
700	70	70	70	700	70	70	70
800	80	80	80	800	80	80	80
900	90	90	90	900	90	90	90
1000	100	100	100	1000	100	100	100

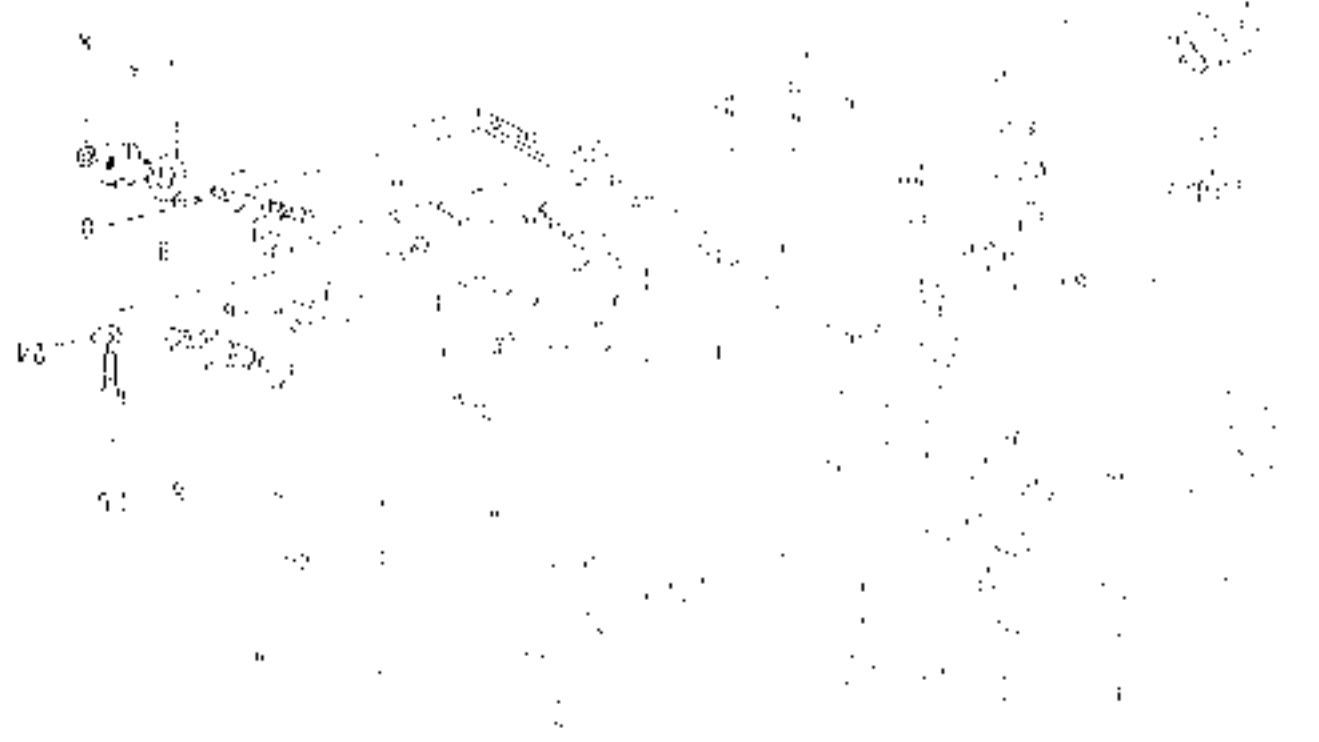

UNIVERSITY OF CHICAGO  
LIBRARY











The following information is provided for the purpose of  
 providing information to the public regarding the  
 results of the audit. The information is provided for  
 informational purposes only and should not be used  
 for any other purpose.

The following information is provided for the purpose of  
 providing information to the public regarding the  
 results of the audit. The information is provided for  
 informational purposes only and should not be used  
 for any other purpose.

Account Number	Description	Amount	Balance
82 1550 007	...	...	...
82 5662 008	...	...	...
81 7432 009	...	...	...
82 5662 040	...	...	...
80 5251 029	...	...	...
82 2151 110	...	...	...
81 4320 100	...	...	...
82 5658 038	...	...	...
82 5658 037	...	...	...
82 5658 036	...	...	...
82 5658 035	...	...	...
82 5658 034	...	...	...
82 5658 033	...	...	...
82 5658 032	...	...	...
82 5658 031	...	...	...
82 5658 030	...	...	...
82 5658 029	...	...	...
82 5658 028	...	...	...
82 5658 027	...	...	...
82 5658 026	...	...	...
82 5658 025	...	...	...
82 5658 024	...	...	...
82 5658 023	...	...	...
82 5658 022	...	...	...
82 5658 021	...	...	...
82 5658 020	...	...	...
82 5658 019	...	...	...
82 5658 018	...	...	...
82 5658 017	...	...	...
82 5658 016	...	...	...
82 5658 015	...	...	...
82 5658 014	...	...	...
82 5658 013	...	...	...
82 5658 012	...	...	...
82 5658 011	...	...	...
82 5658 010	...	...	...
82 5658 009	...	...	...
82 5658 008	...	...	...
82 5658 007	...	...	...
82 5658 006	...	...	...
82 5658 005	...	...	...
82 5658 004	...	...	...
82 5658 003	...	...	...
82 5658 002	...	...	...
82 5658 001	...	...	...

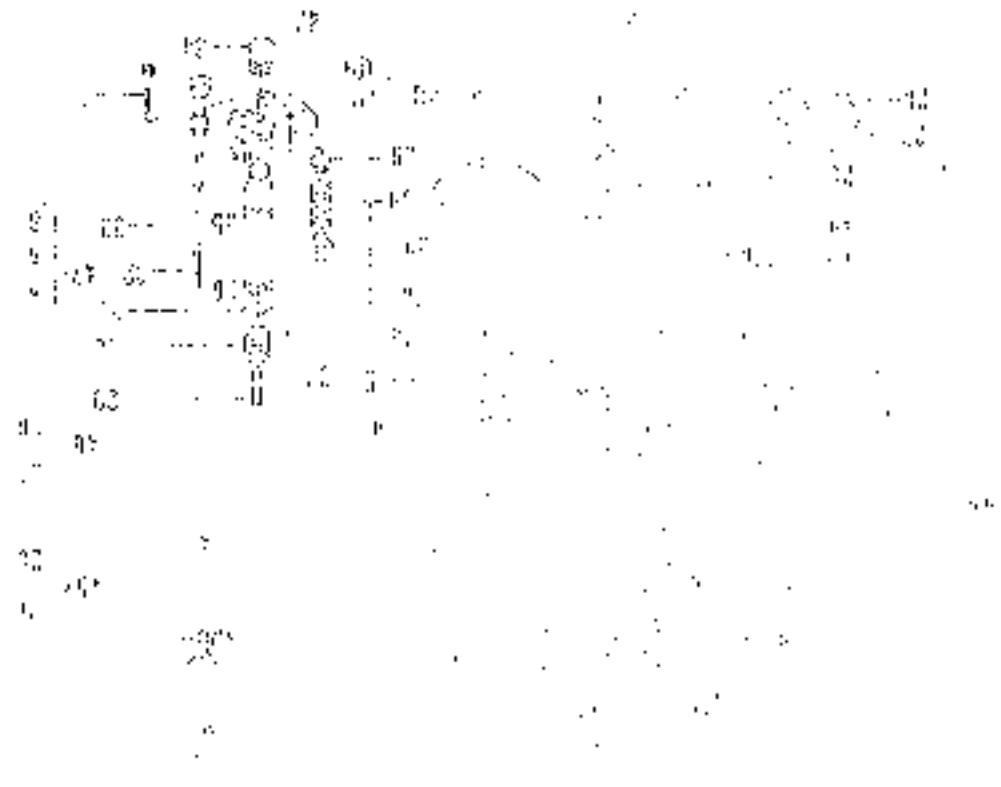

11/11/2018  
 11:20:33 AM

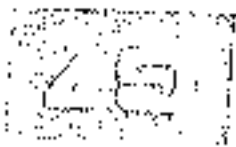

THE UNITED STATES OF AMERICA  
 DEPARTMENT OF THE ARMY  
 HEADQUARTERS  
 WASHINGTON, D.C.

FORM NO. 1  
 1 JAN 63

Serial	Description	Quantity	Unit	Price	Total
1					
2					
3					
4					
5					
6					
7					
8					
9					
10					
11					
12					
13					
14					
15					
16					
17					
18					
19					
20					
21					
22					
23					
24					
25					
26					
27					
28					
29					
30					
31					
32					
33					
34					
35					
36					
37					
38					
39					
40					
41					
42					
43					
44					
45					
46					
47					
48					
49					
50					
51					
52					
53					
54					
55					
56					
57					
58					
59					
60					
61					
62					
63					
64					
65					
66					
67					
68					
69					
70					
71					
72					
73					
74					
75					
76					
77					
78					
79					
80					
81					
82					
83					
84					
85					
86					
87					
88					
89					
90					
91					
92					
93					
94					
95					
96					
97					
98					
99					
100					

UNITED STATES OF AMERICA  
 DEPARTMENT OF THE ARMY  
 WASHINGTON, D.C.



REC'D REV  
 800 P. 22 3M



Organización de España  
Sistema de Clasificación de Vehículos  
Sistema de Clasificación de Vehículos  
Sistema de Clasificación de Vehículos

Clase	Descripción	Código	Valor	Clase	Descripción	Código	Valor
1	...	...	...	1	...	...	...
2	...	...	...	2	...	...	...
3	...	...	...	3	...	...	...
4	...	...	...	4	...	...	...
5	...	...	...	5	...	...	...
6	...	...	...	6	...	...	...
7	...	...	...	7	...	...	...
8	...	...	...	8	...	...	...
9	...	...	...	9	...	...	...
10	...	...	...	10	...	...	...
11	...	...	...	11	...	...	...
12	...	...	...	12	...	...	...
13	...	...	...	13	...	...	...
14	...	...	...	14	...	...	...
15	...	...	...	15	...	...	...
16	...	...	...	16	...	...	...
17	...	...	...	17	...	...	...
18	...	...	...	18	...	...	...
19	...	...	...	19	...	...	...
20	...	...	...	20	...	...	...

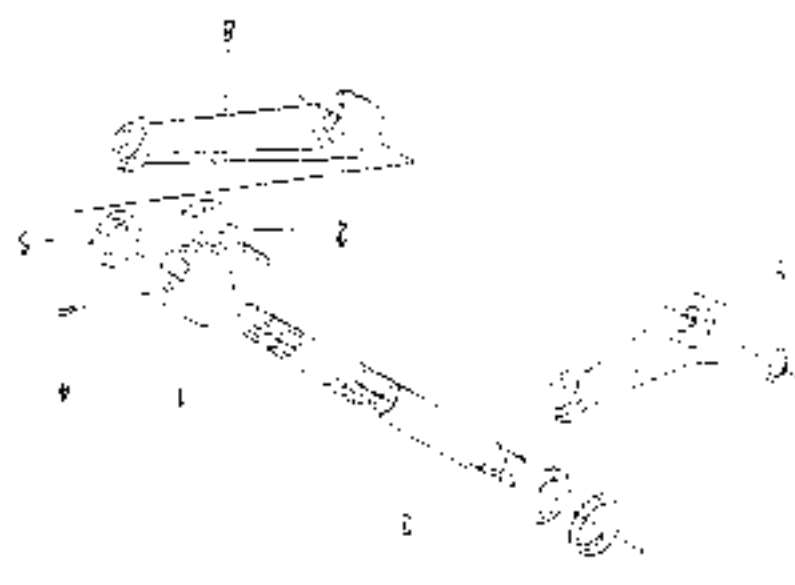

MOD.18/20/22.3W  
TAV.49 REV.1